

DANISH HEATING IDEAS 2014 2015



■ IDENTITY	4
■ SCAN 66 NEW	6
■ SCAN 83 IN NEW COLOURS NEW	12
■ SCAN 85 IN NEW COLOURS NEW	16
■ SCAN 58	20
■ SCAN 64	26
■ SCAN 57	30
■ SCAN 45	32
■ SCANDSA 5	34
■ SCAN 1001 AND SCAN 1002	36
■ SCANDSA FIREPLACE INSERTS	38
■ SCANDSA 11/12	40
■ SCAN ANDERSEN	42
■ BEFORE BUYING A WOOD-BURNING STOVE	44
■ ENVIRONMENTAL CONSIDERATIONS	46
■ ACCESSORIES	47
■ TECHNICAL SUMMARY	48

Scan constantly works to improve its products as much as possible. We reserve the right to make technical changes and change colours and accessories without prior notice. Several of the stoves in this catalogue are illustrated with extra equipment.

DANISH HEATING IDEAS



WARMING IDEAS

Ever since the company was founded in Odense in 1978 we at Scan have focused on offering our customers the best wood-burning stoves on the market, paying particular attention to design, innovation and user-friendliness. For us it is not just about warmth, but about delivering a perfect flame, enclosed in a design-conscious piece of furniture to suit the majority of homes. The combination of Danish design, brave ideas and an eye for detail has turned Scan into a leading brand in wood-burning stoves.

INNOVATION AND NEW THINKING

For Scan heating is more than just a practical or aesthetic matter. We see our stoves as innovative pieces of furniture that suit a modern lifestyle. Through creativity, an eye for detail and the courage to try out new ideas we have pushed ahead and shown the way both in terms of user-friendliness and the environment. Scan was the first to introduce sliding doors, glass with a 90 degree angle and glass handles for inserts.

DANISH DESIGN

Denmark has a rich design tradition, which Scan is a part of. We exclusively use Danish designers to create our stoves, thus ensuring totality and the right expression. Consequently, you can always recognise Scan by the clean lines, which are typical of good Danish design.

We also have a tradition of setting new standards and our designers approach every challenge with the aim of creating something new. This has meant that Scan has constantly gained international recognition and we have won several design awards for our workmanship.

IT'S ALL ABOUT THE DETAIL

At Scan we are focused on the details and put our soul into even the smallest things. With our critical eye and constant search for perfection, we have created revolutionary forms and technical solutions for the benefit of our customers.

By integrating the handles in the design and ensuring easy operation, we have combined form and function. This is one of many examples of what we call a 'smooth finish'.



YOUR NEW FLAME

Enjoying the warmth from a perfect flame behind the stove's glass is the ultimate form of relaxation and enjoyment.

Our design process always focuses on creating extremely beautiful images of the flame and the best view.



Halskov & Dalsgaard





SCAN 66

FLAMES ARE
NOT SQUARE



Celebrated Danish designers, Harrit and Sørensen have again delivered a playful design with innovative features. The organic shape creates a beautiful frame around the fire and the view to the flames is maximized through the use of a glass log retainer. Hang it on the wall or choose between three different leg options, where one has multiple choices for colour inlays.



INNOVATIVE DETAILS

The Scan 66 has many innovative glass details, but the most striking is the log retainer, which is made of clear glass to maximize the view of the flames. The handle and air vents are made of tempered glass that stays cool during firing.

SCAN 66-1



SCAN 66-2



SCAN 66-3



SCAN 66-4



- Choose between wall fitting or one of the three different leg options.
- Weight from 90 kg • Effect: 3-7 kW • 78 % efficiency • Heats up to 260 m³
- Approved for burning wood in DEFRA smoke controlled areas







■ Scan 66-3 is delivered as standard with two silicon inlays. These can easily be exchanged to match your interior.



"Scan 66 draws its inspiration from nature. The organic shape of the stove embrace the flames in a beautiful and holistic way."

Thomas Heint Nielsen



■ Scan 66 has a log retainer made out of clear glass to maximize the view to the fire.



■ The air controls are discretely hidden on the side of the product.





 SCAN83

SIMPLE DESIGN AND BEAUTIFUL DETAILS

The simple design behind the Scan 83 makes your home the centre of attraction, giving you the space to create your own style around the natural gathering place – the play of the flames and the stove's steady warmth.

One of Denmark's strongest design teams, Harrit & Sørensen, is behind the new Scan 83. The clean and simple design was born out of respect for both functionality and aesthetics in equal measure.

Every detail has been thought through. The curved glass door has a soft close function and gives a perfect view of the fire. The handle has been positioned so that it completes the simple design, while remaining cool at the same time. The Scan 83 can be supplied with a revolving base, so that you can enjoy the flames wherever you are in the room.



"An iconic stove in line with the Scan tradition"

Thomas Harrit Nielsen



Scan 83 is now available in more colours. Choose between traditional black or grey paint available for the entire series or the more trendy colours glossy red, white, black or metallic brown for Scan 83-1, 83-2, 83-3 and 83-4.

■ SCAN 83-1



■ SCAN 83-2



■ SCAN 83-3 MAXI



■ SCAN 83-4 MAXI



■ A cylindrical wood-burning stove with a large glass door, providing a good view of the flames.

Choose from a number of variants with or without soap stone, with mouldings and handles in black or aluminium as well as heat-accumulating stones* for the Maxi variant.

The Scan 83 has an ash drawer with lock, cast iron bottom and grate plus adjustable feet. Also available with a revolving base.

- Estimated output: 3-7 kW
- 81 % efficiency
- Heats up to 260 m³
- Approved for burning wood in DEFRA smoke controlled areas 

*Read more about the advantages of Scans heat storage system and heat -accumulating stones on page 45.

■ The integrated soapstone elements stores heat when the fire is burning. When the fire has gone out, this heat is slowly released back into the room.

■ SCAN 83-5



■ SCAN 83-6



■ SCAN 83-7 MAXI



■ SCAN 83-8 MAXI





SCAN 85

EFFECTIVE HEAT IN AN EXCLUSIVE DESIGN

With the Scan 85 the heat quickly spreads across a large area, while you enjoy the simple design and perfect view of the fire. With the high top model you can choose the Heat Storage System, which enables you to enjoy the warmth for up to 12 hours after the final log has been placed on the fire.





COLOURFUL INSPIRATION

With a new colours for the Scan 85, you can now create either contrast or harmony in your home. The whole range is now available in classic grey in addition to the matt black, and the Scan 85-1 and 85-2 had also added a bold red to their colour palette.

NEW! The Scan 85 family is also supplemented with Scan 85-7 and 8 with raised burn chamber that makes it easier to load wood and gives a beautiful view of the fire. Perfect for your dining room or kitchen.



reddot design award
winner 2011

SCAN 85-3 MAXI



SCAN 85-4 MAXI



SCAN 85-5



SCAN 85-6



SCAN 85-7 NEW



SCAN 85-8 NEW



■ Cylindrical smooth surface with full view of the fire. The handle is integrated in the stove and is activated by simply pressing it. Choose from decorative mouldings and handle in black or brushed aluminium as well as heat-accumulating stones* for the Maxi variant. The standard size is also available in new colours; glossy red, black or white and metallic brown.

• Estimated output 3-10 kW • 78 % efficiency • Heats up to 380 m³

*Read more about the advantages of Scans heat storage system and heat -accumulating stones on page 45.



 SCAN 58

ELEGANT ELLIPTICAL SHAPE

The organic elliptical shape is a characteristic feature of the Danish design duo and the perfect proportions provide a unique view of the fire. The simple and aesthetic design has been born out of respect for the central role that the stove will play in your home.





AWARD-WINNING DESIGN

Every detail of the freestanding Scan 58 has been thought through, and the design has won international recognition. The elliptical shape and large glass surfaces invite you to relax a while in front of the flames that you can enjoy from several angles.

The integrated handle operation as easy as the design is simple. The many moulding and pedestal options enable you to make your individual mark on the final design.



reddot design award
honourable mention 2009

■ SCAN 58-1 WITHOUT SIDE WINDOWS



■ SCAN 58-2 WITH SMALL SIDE WINDOWS



■ SCAN 58-3 WITH LARGE SIDE WINDOWS



■ SCAN 58-4 WITHOUT SIDE WINDOWS



■ SCAN 58-5 WITH SMALL SIDE WINDOWS



■ SCAN 58-6 WITH LARGE SIDE WINDOWS



■ Choose from pedestal, see-through base, closed base and wall fitting together with black or aluminium handles and mouldings.

• Estimated output 3-8 kW • 76 % efficiency • Heats up to 300 m³ • Approved for burning wood in DEFRA smoke controlled areas



"The elliptical shape is good for us as there are no edges to catch ourselves on"

Thomas Høist Nielsen





SIMPLE EXPRESSION WITHIN THE WHOLE RANGE

The designers behind the Scan 58-7 and 58-8 have created a slim and elegant stove, which you can keep in its pure form or change its expression by adding soap stone. No matter how you decorate the stove, it still retains its simple proportions. If you want to make use of the heat for as long as possible, an effective choice would be a high top with heat-accumulating stones.

■ SCAN 58-7



■ SCAN 58-8



■ SCAN 58-9



■ SCAN 58-10



■ SCAN 58-8 HIGH TOP



■ SCAN 58-9 HIGH TOP



■ Choose from black or brushed aluminium handles and decorative mouldings and sides in steel or soap stone. Also available as a high top variant with heat-accumulating stones*.

• Estimated output 3-8 kW • 75 / 82 % efficiency • Heats up to 300 m³ • Approved for burning wood in DEFRA smoke controlled areas 

*Read more about the advantages of Scans heat storage system and heat -accumulating stones on page 44.



 SCAN64

CLEAN LINES

Clean lines and a simple design give you a piece of furniture that will suit all your existing decor regardless of style. The Scan 64 has a tranquil look, where a good view of the flames proves extremely attractive.





"By making the stove design simple, each user can shape the expression individually with the details"

Thomas Harrit Nielsen

PERFECT PROPORTIONS

This medium-size stove with large glass door provides a perfect view of the flames and with the many different options you can add your own features to its appearance. All external material choices are integrated into the stove to retain its pure expression. A simple choice that will suit your home.

SCAN 64-1



SCAN 64-2



SCAN 64-3



SCAN 64-4



SCAN 64-7



SCAN 64-8



■ The stove is available with a right or left-hinged door. Black handles and soap stone top are optional extras. The Easylock system allows the door to close by itself without you having to turn a handle. Choose from steel, soap stone or stainless steel sides.

• Estimated output 3-8 kW • 79/82 % efficiency • Heats up to 300 m³ • Approved for burning wood in DEFRA smoke controlled areas 



SCAN 57

SEVERAL ANGLES
TO THE FLAMES

If your wood-burning stove is to play a central role in your home, the Scan 57 is the right choice. In itself, the stove is a unique piece of furniture, and with the rotating base you can enjoy the flames' play from several angles.

SCAN 57



The Scan 57 is supplied with a revolving base. Large combustion chamber with space for logs up to 56 cm in length.

- Estimated output 3-9 kW
- 78 % efficiency
- Heats up to 340 m³
- Approved for burning wood in DEFRA smoke controlled areas 





S SCAN 45

CLASSIC
AND SLIM

In smaller rooms the wood-burning stove should not dominate, but supplement the style and size. The Scan 45 has been designed with a slim expression, which discretely creates harmony in the home. Elegant details such as the stainless steel inset at the top of the door complete the elegant look.

■ SCAN 45 BLACK



■ SCAN 45 GREY



- Option to vary the design with a soap stone top plate for a rear or top flue outlet.
The handle stays cool when the stove is in use, and the lid on the ash drawer makes emptying easy.
- Estimated output 3-7 kW • 82,5 % efficiency • Heats up to 260 m³







SCANDSA 5

THE FASHION OF BEING UNIQUE

If you are looking for a stove with personality, then this is the clear choice. As both a free standing and wall model, the Scan DSA 5 stands out fashionably and stylishly from the crowd. The easy to operate lifting door makes using your stove a pleasure and the underlying technology ensures clean and environmentally neutral combustion.

 SCAN DSA 5 FREE STANDING



 SCAN DSA 5 WALL-MOUNTED



 Available in grey, black or stainless steel and as freestanding or wall-mounted. A front shelf in soap stone, granite, black, grey or stainless steel makes individual expression possible.

Covers for the smoke pipe are available as an accessory in heights of 400 mm, 500 mm or made to measure. A connection piece for fresh air supply is available for the free standing model.

• Estimated output 3-10 kW • 77 % efficiency • Heats up to 380 m³

SCAN 1001/1002

STYLISH AND BEAUTIFUL, EVEN WHEN UNLIT

The discrete and exclusive built-in model is available in classic black or modern white. A cool glass handle on the door completes the pure expression and separates the model from its competitors on the market.

SCAN 1001 BB



SCAN 1002 WC



Choose from white or black glass decor and trims in black or matt chrome. Both models are available with a right or left-hinged door.

- Estimated output 3-9/3-10 kW • 82 % efficiency • Heats up to 340/380 m³
- Approved for burning wood in DEFRA smoke controlled areas 
- Connection for fresh air



*"We want to create a design
that raises quality of life and
we're eternally curious to know
what's going in the world"*

Christina Haklar. Home Design



S SCAN DSA FIREPLACE INSERTS

LIVING ART ON THE WALL

Built-in fireplaces gives the wood-burning stove a different role than the traditional one. Before lighting the fire the expression is unobtrusive, when the fire is blazing, the flames create living art on the wall. This is a clear choice when renovating open fireplaces or building new ones.



■ SCAN DSA 3-2 CURVED GLASS



■ SCAN DSA 3-5 FLAT GLASS



■ **SCANDSA 3 AND 4** Available in black or grey paint with trims in various standard sizes or custom-made.

A connection piece for fresh air inlet at the bottom is optional*. ** The Scan DSA 3-2 and 3-5 are fitted with ash drawers and riddling grates.

- Estimated output: 3-8 kW
- 77 / 78 % efficiency
- Heats up to 300 m³

■ SCAN DSA 4-2 CURVED GLASS



■ SCAN DSA 4-5 FLAT GLASS



■ **SCANDSA 7-5** The large combustion chamber enables you to use extra large pieces of wood.

The insert is available in black with a steel handle extended by the decorative moulding.

The trims are available custom-made, and a connection piece for fresh air inlet at the bottom is optional*. **

- Estimated output 3-9 kW • 78 % efficiency
- Heats up to 340 m³
- Approved for burning wood in DEFRA smoke controlled areas 

■ SCAN DSA 6



■ **SCANDSA 6** Space-saving and functional insert with high-format black frame.

The decorative moulding in chromed steel extends the operating handle, which maintains a touch-friendly temperature.

The trims are available custom-made, and a connection piece for fresh air inlet at the bottom is optional*. **

- Estimated output 3-7 kW
- 83 % efficiency
- Heats up to 260 m³

■ SCAN DSA 7-5



*Not suitable for UK installations.

**Does not have closed combustion

S SCANDSA 11

S SCANDSA 12

DISCRETE AND WELL-CONSIDERED DESIGN

Although a built in wood-burning stove is only visible as a living painting on the wall, it distributes its heat optimally. Additional fittings can increase the possibility of optimal heat distribution from the stylish stove with functional details like the handle, which lies flush with the front.





■ SCANDSA 12



■ **SCANDSA 12** A fireplace insert with glass on both sides enabling you to see right through.

It can be operated from both sides, but one door can be locked, if you only wish to operate it from one side. Closed combustion is standard.

- Estimated output 5-11 kW
- 80 % efficiency
- Heats up to 425 m³

■ SCANDSA 11



■ **SCANDSA 11** The large combustion chamber has room for logs up to 50 cm in length.

An optional fan distributes the warm air and is fitted concealed under the combustion chamber.

- Estimated output 5-12 kW
- 70 % efficiency
- Heats up to 450 m³

S SCAN ANDERSEN

AUTHENTIC TOP QUALITY IN PURE CAST IRON

If you want the embracing warmth to come from a classic, cast iron wood-burning stove, there are a number of rustic, top quality options. With soap stone sides you can vary the look within a wide range of stoves that all generate a classic mood and steady warmth.

S SCAN ANDERSEN 4-5 RADIANT ON SHORT LEGS



SCAN ANDERSEN 4-5 CONVECTION



SCAN ANDERSEN 4-5 SOAP STONE



SCAN ANDERSEN 4-5 Available as a black convection model, soap stone on the sides and top or with short legs.

A riddling grate in the combustion chamber allows the ash to drop into the ash drawer.

The chrome handle can be fixed or detachable for child safety.

- Estimated output 3-6 kW
- 77 % efficiency
- Heats up to 220 m³
- Approved for burning wood in DEFRA smoke controlled areas 

SCAN ANDERSEN 8-2 CONVECTION



SCAN ANDERSEN 8-2 WITH SHORT LEGS



SCAN ANDERSEN 8-2 Available as a black convection model, soap stone on the sides and top or with short legs.

Both models have a large combustion chamber, and the heat is regulated by a simple handle.

The chrome handle can be fixed or detachable for child safety. Ash drawer and riddling grate are standard.

- Estimated output 3-9 kW
- 79 % efficiency
- Heats up to 340 m³
- Approved for burning wood in DEFRA smoke controlled areas 

SCAN ANDERSEN 10 CONVECTION



SCAN ANDERSEN 10 SOAP STONE



SCAN ANDERSEN 10 Available as a black convection stove or with soap stone sides and top. A soap stone top plate gives off additional heat even after the fire has gone out.

The large combustion chamber has room for long logs, enabling a high output and fewer refills.

The position of the chrome handle prevents it from becoming hot when stoking. Riddling grate and ash drawer are standard.

- Estimated output 3-9 kW
- 79 % efficiency
- Heats up to 340 m³

BEFORE BUYING A WOOD-BURNING STOVE

For most of us, a wood-burning stove is a big investment that we want to last for many years. It is therefore important to check out the conditions in your home before deciding.

CHIMNEY

If your home does not have a chimney, ask the dealer about the possibility of getting a chimney to suit your stove.

If you already have a chimney, it is important to get it checked to make sure it is in a usable condition.



SAFETY

Our approvals are your guarantee that your wood-burning stove has been thoroughly tested and checked. All products are tested in terms of safety and function. We therefore automatically give a 5-year (excluding consumable items) right to claim. Selected authorised Scan dealers are available with further technical information regarding installation and service etc. See also www.scan.dk

APPROVAL

A wood-burning stove must be safe when in use, easy to operate and protect the environment.

It is therefore a good idea if the stove does not just meet the national standards and requirements.

SIZE

It is important to get a stove that is proportioned for the area it has to heat.

CLEARANCE

Take note of the applicable regulations regarding clearances to combustible material and the correct floor covering.

The authorised Scan dealer will be happy to advise you on the regulations.

INFORMATION ON INSTALLATION

To avoid installing the stove incorrectly and to ensure correct use, it is important to follow the assembly and instructions manual carefully.

We recommend that the installation is performed by an authorised Scan fitter to ensure optimum function and safety of the installation.

Information on Scan dealers can be found at www.scan.dk.

As the house owner you are responsible for ensuring that installation and fitting are carried out in accordance with national and local building regulations as well as the information provided in the assembly and instructions manual.

If you want to do the fitting yourself, you should make sure you can do it safely and according to the applicable regulations.

As the house owner you must register the installation of a new fireplace with the local chimney sweep and/or building authorities (always respect the national rules in your country).



QUALITY

All Scan stoves are characterised by their high quality and are produced from the best possible materials. We conduct a thorough goods inwards inspection of raw materials and final inspection of the product. Via a registration number, it is possible to trace the origin of the stove which makes ordering spare parts easier.

Unique details such as a cool handle, efficient air wash and simple operation are quality features - and make lighting and stoking much easier.

KEEPS HEATING FOR LONGER

Scan's unique Heat Storage System gives you the opportunity to have extra warmth for up to 12 hours after putting in the last log.

The Heat Storage System is a combination of materials and technical design that ensures maximum heat output long after the fire has gone out.

The Heat Storage System is compact and concealed inside the top of the stove. Here the heat-accumulating



material collects the heat produced in the combustion chamber. A valve in the top of the stove is standard on Scans heat accumulating products. Stoking with the valve open delivers heat faster. When the valve is closed, the heat is stored, and heat emission is extended by up to 12 hours.

WOOD-BURNING STOVES MEET ENVIRONMENTAL CONSIDERATIONS

Burning wood is a sustainable and economic form of energy. If the wood-burning stove has been designed correctly, you save fuel. At Scan we strive constantly to increase the efficiency of the combustion and meet the most stringent of international requirements. Scan is therefore among the producers of wood-burning stoves that has achieved most approvals on the international stage.

A number of our products have also been awarded the official Nordic Swan ecolabel. The Swan ecolabel guarantees that the products are among the best and cleanest on the market, that we consider your health, and that the products are high quality.



A FOCUS ON ENVIRONMENTALLY- FRIENDLY HEATING

Scan's objective is to develop wood-burning stoves that burn more cleanly and more economically than all others.



FRESH AIR / EXTERNAL COMBUSTION AIR

There are two forms of air supply:

- Air that is fed into the room from outside
- External combustion air that is fed directly into the combustion chamber



Instead of opening a window and risking the cold and draughts, you can feed air directly into the room from outside via a fresh air branch pipe. Doing this replaces the air that has been used during combustion. The branch pipe can be fitted to the back of the stove or as a box under the combustion chamber. Most Scan models can be equipped with this form of fresh air supply after installation, too.

In well-insulated houses it can be a good idea to feed air directly into the combustion chamber from outside, in other words external combustion air. This is especially important in houses with mechanical ventilation or cooker hoods close to the place of installation. It is possible to feed external combustion air to most Scan models at the back of the stove or in the bottom.

Some models must be ordered from the factory prepared for external combustion air, whereas external combustion air with rear outlet can be retro-fitted on the vast majority of Scan stoves.

See also the technical data from page 48 and the manual at www.scan.dk.

UNIQUE COMBUSTION SYSTEM

The highly developed combustion system, Clean Burn, ensures that our wood-burning stoves are technological forerunners and set new standards for high efficiency and low CO₂ emissions and wood consumption. The through-flow of air also ensures that the glass remains optimally clean.

Clean Burn was developed to meet the strictest international requirements for clean burning and to protect both people and the environment.



Models in our range indicated with this logo are DEFRA exempt, this enables the appliance to burn wood in a UK smoke controlled area.



ACCESSORIES

When you choose Scan, you will have a stylish Danish design with functional and exclusive details. Find the ultimate finish for your Scan wood-burning stove among our wide range of accessories.



FLOOR PLATES

We have a large selection of floor plates. They are available in various materials, shapes and colours. There are also special shaped floor plates for almost all models (see technical information from pages 48).

The floor plate is not just a practical measure. It also completes the stove's design. Your dealer can give you more information on the various floor plate possibilities. They are typically available in hardened glass and steel, and in many sizes and designs.

Remember to check that the floor plate you choose complies with the building regulations.



FLUE PIPES

We have a wide range of high-quality flue pipes. Our authorised dealers can help you find the product that best suits your needs.



WOOD BASKETS AND COMPANION SETS

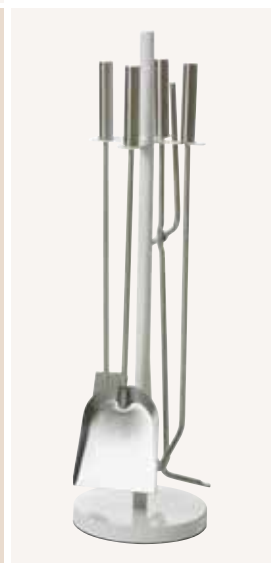

TECHNICAL DATA

Free Standing Stoves (according to EN 13240):	Scan 45	Scan 57	Scan 58-1 Scan 58-4	Scan 58-2 Scan 58-5	Scan 58-3 Scan 58-6	Scan 58-7 Scan 58-8	
EN nominal performance (kW)	5	7	5,5	5,5	5,5	5,5	
Efficiency (%)	82,5	78	76	76	76	75	
Emission (% CO at 13% O ₂)	0,10	0,11	0,11	0,11	0,11	0,07	
Distance to combustible materials uninsulated start section, sides/rear/corner (mm) (A/B/C). For revolving stoves, see the manual	200/150/150	200/200/80 (with firm base)	350/250/200	600/250/250	600/250/400	350/250/200	
Other Properties:							
Est. operating range (kW)	3-7	3-9	3-8	3-8	3-8	3-8	
Room size approx. (m ³)	50-260	75-340	50-300	50-300	50-300	50-300	
Max. log length (cm)	25	56	30	30	30	30	
Weight (kg)	90	204	100	100	100	100	
Dimensions HxWxD (mm) *	969x414x412	1039x979x461	1138x500x350	1138x500x350	1138x500x350	1140x500x350	
Height to the middle of flue outlet rear (mm):	831	-	998	998	998	1000	
Height to the beginning of flue pipe at top outlet (mm):	932	988	1112	1112	1112	1114	
Fire box opening HxB (mm)	400x277	290x610	320 x 310	320 x 310	320 x 310	320 x 310	
Flue outlet (mm)	Ø 150	Ø 155 int.	Ø 150	Ø 150	Ø 150	Ø 150	
Clean Burn	•	•	•	•	•	•	
Approvals:							
EN 13240	•	•	•	•	•	•	
NS 3058	•	•	•	•	•	•	
Nordic Eco-Label (The Swan)	-	-	•	•	•	•	
DEFRA	-	•	•	•	•	•	
Stove colour/lateral covering/side windows:							
Black	□	•	•	•	•	•	
Grey	□	-	-	-	-	-	
Soap stone	-	-	-	-	-	-	
Stainless steel	-	-	-	-	-	-	
Glossy white (GWH)	-	-	-	-	-	-	
Glossy black (GBL)	-	-	-	-	-	-	
Metallic brown (MBR)	-	-	-	-	-	-	
Glossy red (GLR)	-	-	-	-	-	-	
Side windows	-	-	-	•	•	-	
Extra accessories:							
Top plate soap stone	▲	-	▲	▲	▲	▲	
Top plate glass	-	-	▲	▲	▲	▲	
High top element	-	-	-	-	-	▲	
Heat accumulating stones	-	-	-	-	-	▲	
Shaped floor plate glass	▲	▲	▲	▲	▲	▲	
Shaped floor plate steel	▲	▲	▲	▲	▲	▲	
Option of closed combustion system *)	▲	-	•	•	•	•	

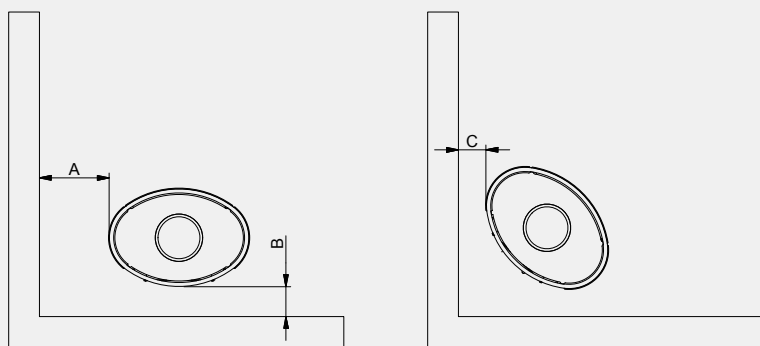

Measurement drawing:
The most standard clearances to combustible material are shown in the table, in which the measurements are referred to as A, B and C.
See www.scan.dk for further information.

- = standard
- = option *)
- ▲ = extras

*) see further details in the manual on scan.dk
**) placed vertically

Some options can be at a supplementary price
We refer to the manuals for distances to combustible materials

	Scan 58-9 Scan 58-10	Scan 58-7 Scan 58-8 High Top	Scan 58-9 Scan 58-10 High Top	Scan 58 Wall	Scan 64-1 Scan 64-3 Scan 64-7	Scan 64-2 Scan 64-4 Scan 64-8	Scan 66-1	Scan 66-2 Scan 66-3 Scan 66-4
	5,5	5,5	5,5	5,5	6	6	5	5
	75	82	82	76	82	79	78	78
	0,07	0,07	0,07	0,11	0,08	0,10	0,03%	0,03%
	350/250/200	350/250/200	350/250/200	To sides: 1-4: 350mm 2-3-5-6: 600mm	350/150/100	500/150/250	sides 300	300/150/150
	3-8	3-8	3-8	3-8	3-8	3-8	3-7	3-7
	50-300	50-300	50-300	50-300	50-300	50-300	50-260	50-260
	30	30	30	30	30	30	33	33
	160-175	120-200	180-275	100	117-180	117-180	90	100
	1140x586x350	1572x500x350	1572x586x350	764x500x350	1131x490x380	1131x490x380	630x485x337	946,5x485x337
	1000	1000	1000	624	1011	1011	From top 148,5	788
	1114	1114	1114	728	1110	1110	-	883
	320 x 310	320 x 310	320 x 310	320 x 310	326x364	326x364	239x340	239x340
	Ø 150	Ø 150	Ø 150	Ø 150	Ø 150	Ø 150	Ø 150	Ø 150
	●	●	●	●	●	●	●	●
	●	●	●	●	●	●	●	●
	●	●	●	●	●	●	●	●
	●	●	●	●	●	●	●	●
	●	●	●	●	●	●	●	●
	●	●	●	●	□	□	●	●
	-	-	-	-	□	□	-	-
	●	-	●	-	□	□	-	-
	-	-	-	-	□	□	-	-
	-	-	-	-	-	-	-	-
	-	-	-	-	-	-	-	-
	-	-	-	-	-	-	-	-
	-	-	-	-	-	-	-	-
	-	-	-	□	-	●	-	-
	(large / small) ▲	▲	(large / small) ▲	▲	▲	▲	-	-
	-	▲	-	▲	-	-	-	-
	▲	●	●	-	-	-	-	-
	▲	▲	▲	-	-	-	-	-
	▲	▲	▲	-	▲	▲	-	(Scan 66-2) ▲
	▲	▲	▲	-	▲	▲	-	(Scan 66-2) ▲
	●	●	●	●	●	●	●	●

Free Standing Stoves (according to EN 13240):	Scan 83-1/2 Scan 83-5/6	Scan 83-3/4 Scan 83-7/8	Scan 85-1 Scan 85-2	Scan 85-3 Scan 85-4	Scan 85-5 Scan 85-6	Scan 85-7 Scan 85-8	
EN nominal performance (kW)	5	5	8	8	8	8	
Efficiency (%)	81	81	78	78	78	78	
Emission (% CO at 13% O ₂)	0,07	0,07	0,06	0,06	0,06	0,06	
Distance to combustible materials uninsulated start section, sides/rear/corner (mm) (A/B/C). For revolving stoves, see the manual	400/100/100	400/100/100	600/100/100	600/100/100	600/100/100	600/100/100	
Other Properties:							
Est. operating range (kW)	3-7	3-7	3-10	3-10	3-10	3-10	
Room size approx. (m ³)	50-260	50-260	75-380	75-380	75-380	75-380	
Max. log length (cm)	35 **)	35 **)	50 **)	50 **)	50 **)	50 **)	
Weight (kg)	117-186	125-212	210	229-319	220-310	220	
Dimensions HxWxD (mm) *)	1200x460x460	1410x460x460	1464x520x520	1864x520x520	1664x520x520	1664x520x520	
Height to the middle of flue outlet rear (mm):	1064	1064	1347	1547	1347	1547	
Height to the beginning of flue pipe at top outlet (mm):	1162	1162	1442	1642	1442	1642	
Fire box opening HxB (mm)	388x353	388x353	447x327	447x327	447x327	447x327	
Flue outlet (mm)	Ø 150	Ø 150	Ø 150	Ø 150	Ø 150	Ø 150	
Clean Burn	●	●	●	●	●	●	
Approvals:							
EN 13240	●	●	●	●	●	●	
NS 3058	●	●	●	●	●	●	
Nordic Eco-Label (The Swan)	●	●	●	●	●	●	
DEFRA	●	●	-	-	-	-	
Stove colour/lateral covering/side windows:							
Black	□	□	□	□	□	□	
Grey	□	□	□	□	□	□	
Soap stone	(Scan 83-5/6) □	(Scan 83-7/8) □	-	-	-	-	
Stainless steel	-	-	-	-	-	-	
Glossy white (GWH)	(Scan 83-1/2) □	(Scan 83-3/4) □	□	-	-	-	
Glossy black (GBL)	(Scan 83-1/2) □	(Scan 83-3/4) □	□	-	-	-	
Metallic brown (MBR)	(Scan 83-1/2) □	(Scan 83-3/4) □	□	-	-	-	
Glossy red (GLR)	(Scan 83-1/2) □	(Scan 83-3/4) □	□	-	-	-	
Side windows	-	-	-	-	-	-	
Extra accessories:							
Top plate soap stone	▲	▲	-	-	-	-	
Top plate glass	-	-	-	-	-	-	
Short legs	-	-	-	-	-	-	
High top element	-	●	-	●	●	-	
Heat accumulating stones	-	▲	-	▲	▲	-	
Shaped floor plate glass	▲	▲	▲	▲	▲	▲	
Shaped floor plate steel	▲	▲	▲	▲	▲	▲	
Option of closed combustion system *)	●	●	●	●	●	●	

● = standard
□ = option *)
▲ = extras

*) see further details in the manual on scan.dk
**) placed vertically

Some options can be at a supplementary price

We refer to the manuals for distances to combustible materials

	Scan Andersen 4-5 Convection	Scan Andersen 4-5 Soap Stone	Scan Andersen 8-2 Convection	Scan Andersen 8-2 Soap Stone	Scan Andersen 10 Convection	Scan Andersen 10 Soap Stone	Scan DSA 5	Scan DSA 5 Wall
	4,5	4,5	7	7	7	7	8	8
	77	77	79	79	79	79	77	77
	0,09	0,09	0,09	0,09	0,07	0,07	0,11	0,11
	300/300/300	300/300/300	250/200/200	450/200/200	300/150/150	300/150/150	500/150/300	To sides:500
	3-6	3-6	3-9	3-9	3-9	3-9	3-10	3-10
	50-220	50-220	75-340	75-340	75-340	75-340	75-380	75-380
	30	30	35	35	50	50	40	40
	92	164	130	200	140	240	210	190
	758x474x453	821x532x453	874x557x464	937x598x464	889x676x405	889x676x405	1650x774x608	1382x774x657
	651	651	764	764	774	774	1374	1184
	-	-	-	-	-	-	-	-
	200x305	200x305	320x370	320x370	290x475	290x475	435x490	435x490
	Ø 130	Ø 130	Ø 150	Ø 150	Ø 150	Ø 150	Ø 180	Ø 180
	•	•	•	•	•	•	-	-
	•	•	•	•	•	•	•	•
	•	•	•	•	•	•	•	•
	-	-	-	-	-	-	•	•
	•	•	•	•	-	-	-	-
	•	•	•	•	•	•	□	□
	-	-	-	-	-	-	□	□
	-	•	-	•	-	•	-	-
	-	-	-	-	-	-	□	□
	-	-	-	-	-	-	-	-
	-	-	-	-	-	-	-	-
	-	-	-	-	-	-	-	-
	-	-	-	-	-	-	-	-
	-	-	-	-	-	-	-	-
	-	-	-	-	-	-	-	-
	-	▲	▲	▲	▲	▲	-	-
	-	-	-	-	-	-	-	-
	▲	-	▲	-	-	-	-	-
	-	-	-	-	-	-	-	-
	-	-	-	-	-	-	-	-
	-	-	-	-	-	-	▲	-
	-	-	-	-	-	-	▲	-
	-	-	-	-	-	-	-	-

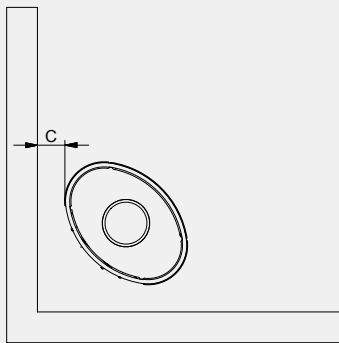
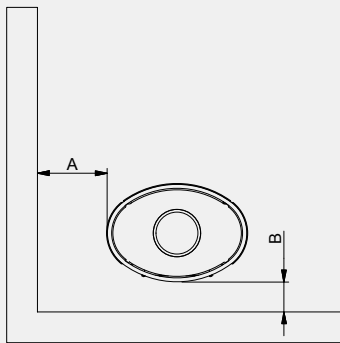

Measurement drawing:

The most standard clearances to combustible material are shown in the table, in which the measurements are referred to as A, B and C.

See www.scan.dk for further information.

Inserts (according to EN 13229)	DSA 3-2 DSA 3-5	DSA 4-2 DSA 4-5	DSA 6	DSA 7-5	DSA 11	DSA 12	SCAN 1001	SCAN 1002
EN nominal performance (kW)	6	6	5	7	10	9	7	8
Efficiency (%)	77	78	83	78	70	80	82	82
Emission (% CO at 13% O ₂)	0,10	0,10	0,10%	0,11	0,16	0,09	0,07	0,07
Other Properties:								
Est. operating range (kW)	3-8	3-8	3-7	3-9	5-12	5-11	3-9	3-10
Room size approx. (m ³)	50-300	50-300	50-260	75-340	75-450	75-425	75-340	75-380
Max. log length (cm)	40	40	30	55	50	50	33	50
Weight (kg)	85	77	78	85	100	210	107	124
Dimensions HxWxD (mm)	614x 606x390	540x 606x391	668x 416x415	536x 726x367	590x 730x420	989x 840x460	570x 650x438	570x 800x438
Height to the middle of flue outlet rear (mm):	-	-	-	-	-	-	489	489
Fire box opening HxB (mm)	320x465	320x465	370x320	290x610	306x612	295x550	334x521	334x671
Flue outlet ext./int. flue pipe (mm)	Ø159/Ø155	Ø159/Ø155	Ø159/Ø155	Ø159/Ø155	Ø179/Ø175	Ø179/Ø175	Ø148/Ø144	Ø148/Ø144
Flue outlet ext. Flexible pipe (mm)	Ø149	Ø149	Ø149	Ø149	-	-	-	-
Clean Burn	●	●	●	●	●	●	●	●
Approvals:								
EN 13229	●	●	●	●	●	●	●	●
NS 3058	●	●	●	●	-	●	●	●
Nordic Eco-Label (The Swan)	-	-	●	-	-	●	●	●
DEFRA	-	-	-	●	-	-	●	●
Stove colour:								
Black	□	□	●	●	●	●	●	●
Grey	□	□	-	-	-	-	-	-
Extra accessories:								
Trim black, standard	□	□	●	●	●	●	□	□
Trim grey, standard	□	□	-	-	-	-	-	-
Trim chrome, standard	-	-	-	-	-	-	□	□
Custom made trims	▲	▲	▲	▲	▲	▲	▲	▲
Possibility for fresh air inlet in the convection channels **)	▲	▲	▲	▲	-	-	-	-
Option of closed combustion system **)	-	-	-	-	-	●	●	●

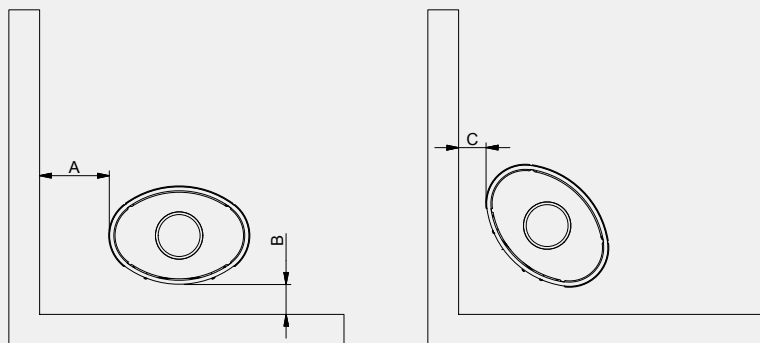

Measurement drawing:
The most standard clearances to combustible material are shown in the table, in which the measurements are referred to as A, B and C.
See www.scan.dk for further information.

- = standard
- = option *)
- ▲ = extras

*) see further details in the manual on scan.dk
Some options can be at a supplementary price
We refer to the manuals for distances to combustible materials

SCAN 45

PAGE 32

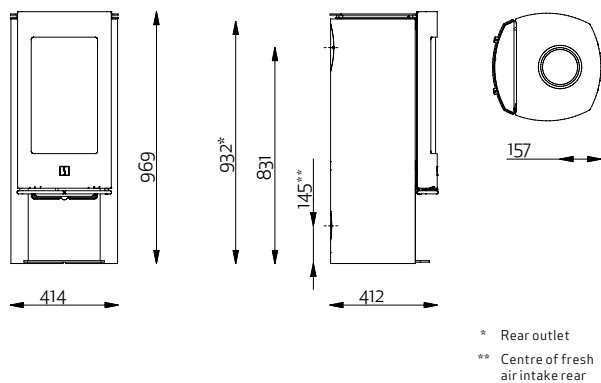

SCAN 58-1 / 58-4

PAGE 20

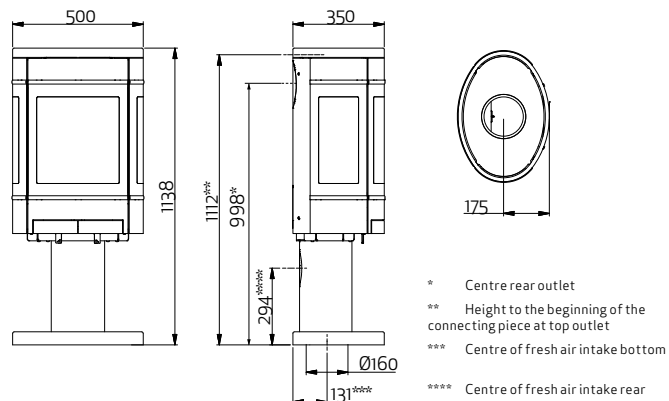

SCAN 57

PAGE 30

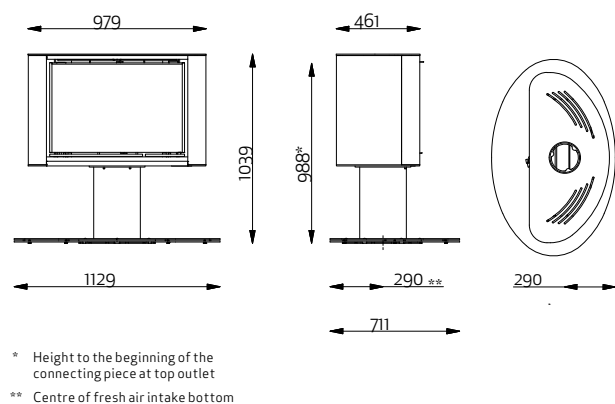

SCAN 58-2 / 58-5

PAGE 20

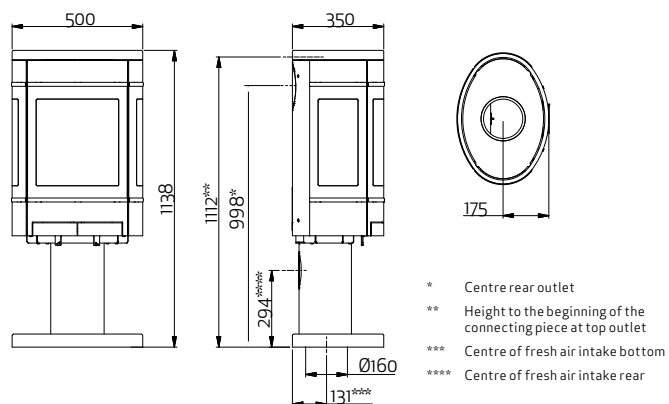

SCAN 58 Wall

PAGE 20

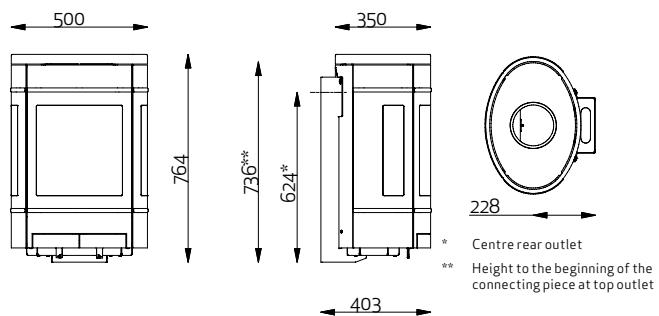

SCAN 58-3 / 58-6

PAGE 20

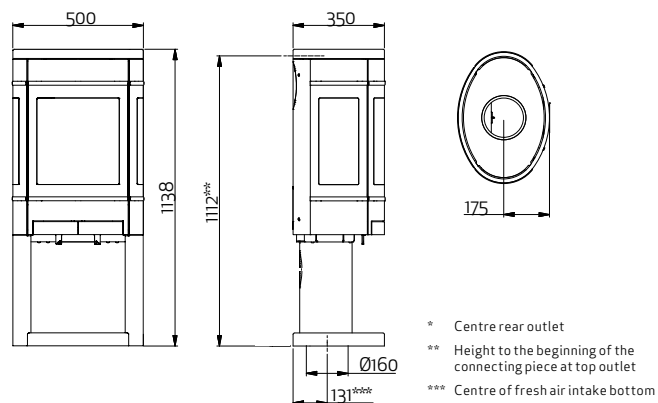

SCAN 58-7/8

PAGE 25

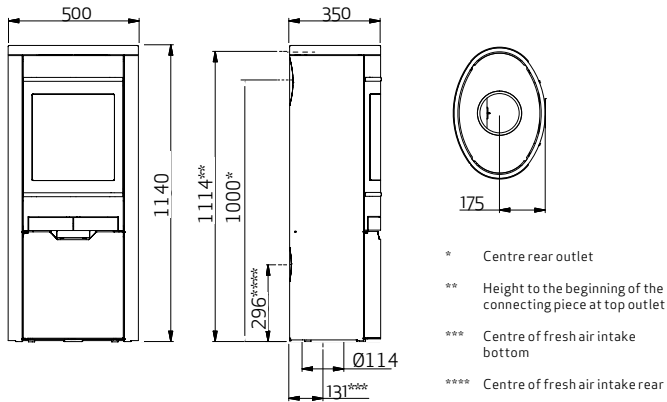

SCAN 58-9/10 HIGH TOP

PAGE 25

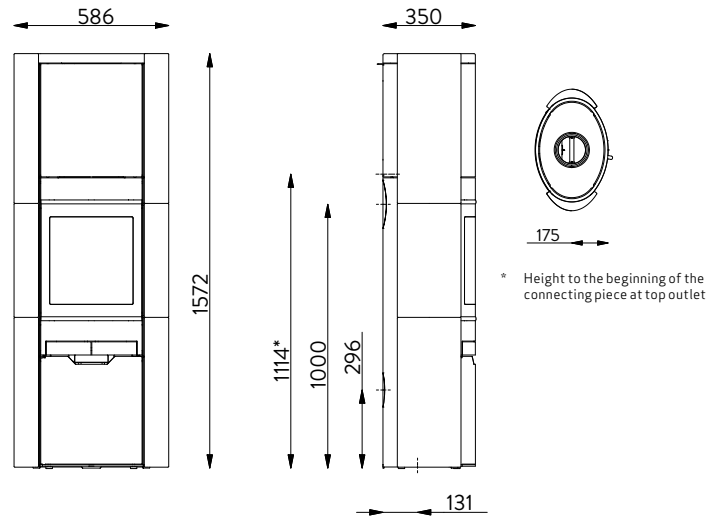

SCAN 58-7/8 HIGH TOP

PAGE 25

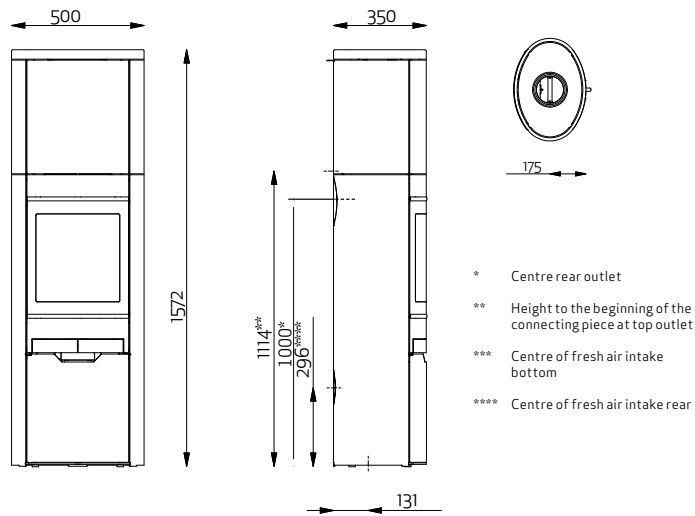

SCAN 64-1/3/7

PAGE 26

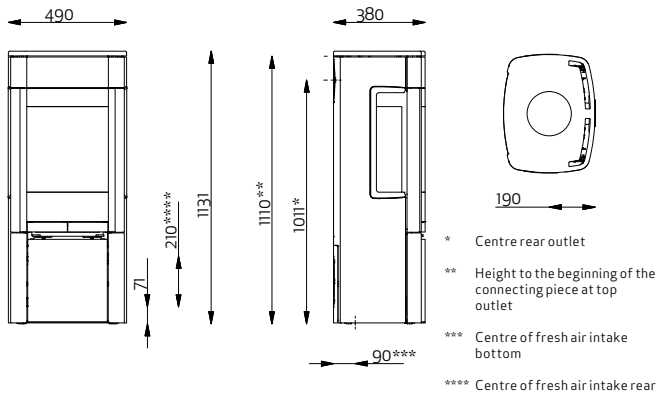

SCAN 58-9/10

PAGE 25

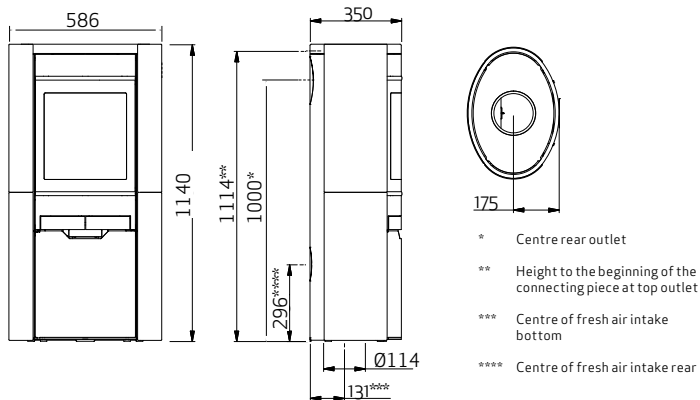

SCAN 64-2/4/8

PAGE 26

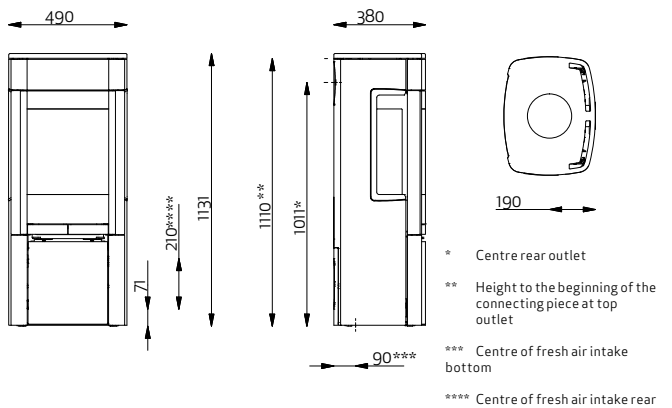

SCAN 66-1

PAGE 6

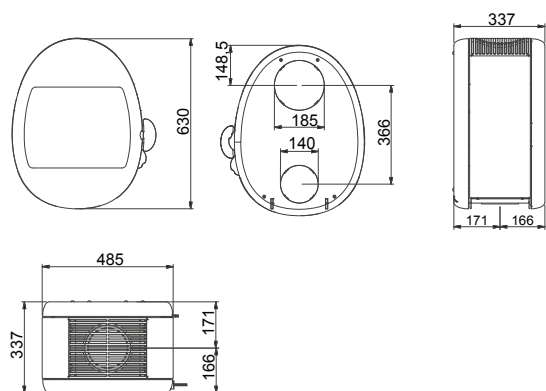

SCAN 66-4

PAGE 6

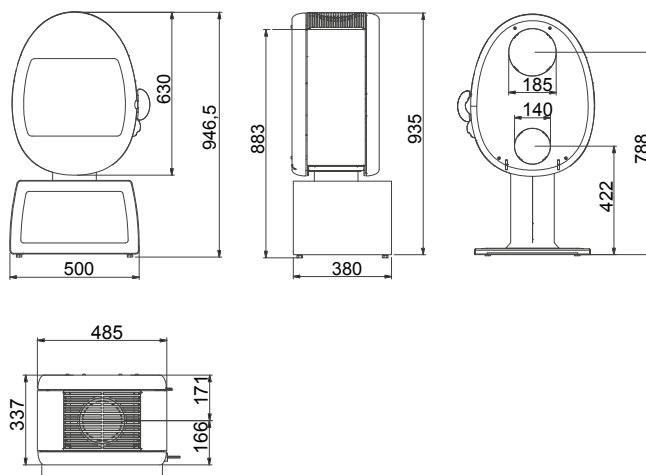

SCAN 66-2

PAGE 6

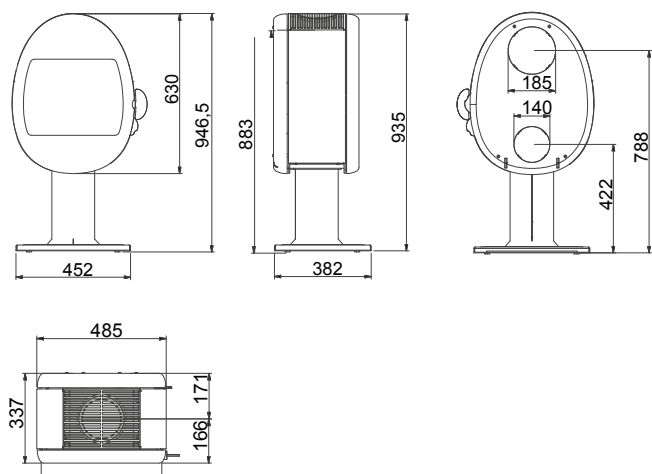

SCAN 83-1/2/5/6

PAGE 13

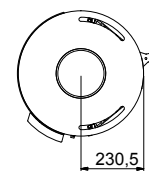
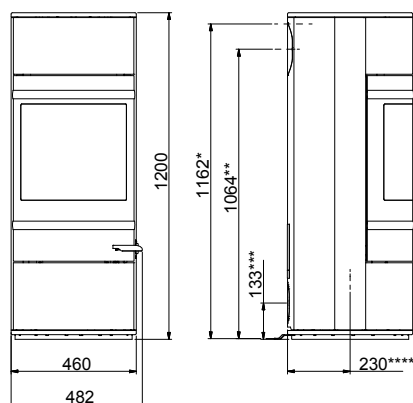

- * Height to the beginning of the connecting piece at top outlet
- ** Centre rear outlet
- *** Centre of fresh air intake rear
- **** Centre of fresh air intake bottom

SCAN 66-3

PAGE 6

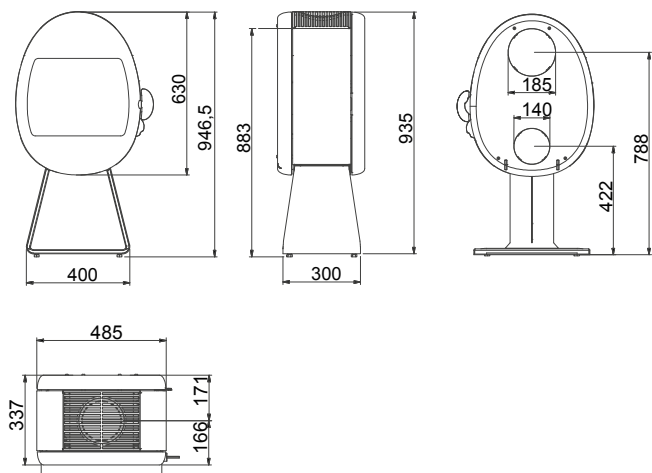

SCAN 83-3/4/7/8 MAXI

PAGE 13

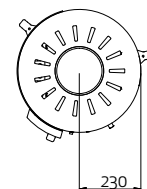
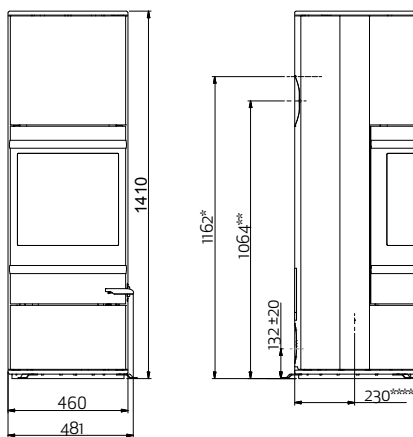

- * Height to the beginning of the connecting piece at top outlet
- ** Centre rear outlet
- *** Centre of fresh air intake rear
- **** Centre of fresh air intake bottom

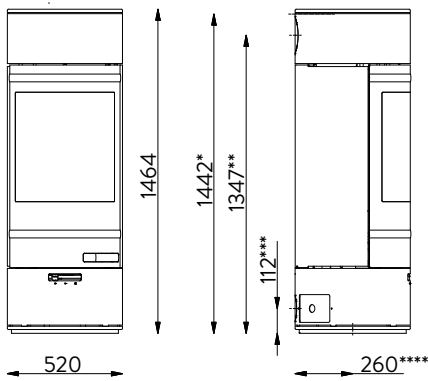

- * Height to the beginning of the connecting piece at top outlet
- ** Centre rear outlet
- *** Centre of fresh air intake rear
- **** Centre of fresh air intake bottom

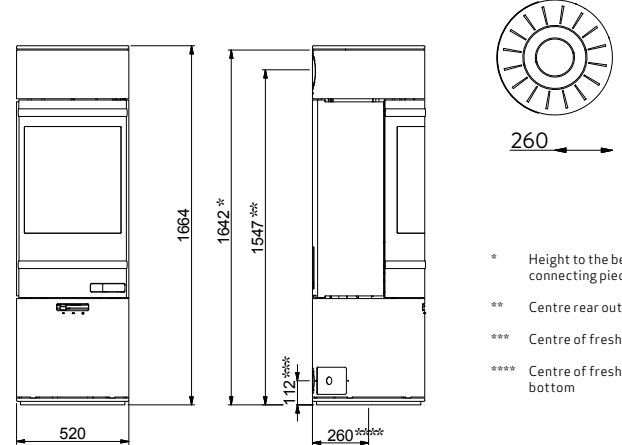

- * Height to the beginning of the connecting piece at top outlet
- ** Centre rear outlet
- *** Centre of fresh air intake rear
- **** Centre of fresh air intake bottom

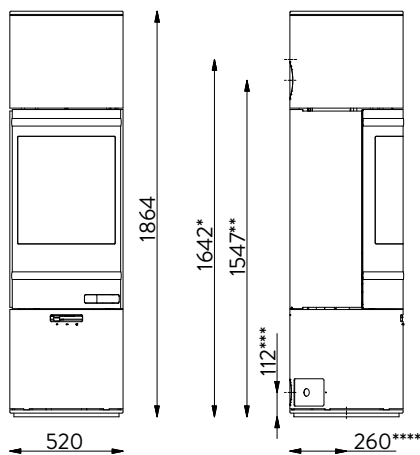

- * Height to the beginning of the connecting piece at top outlet
- ** Centre rear outlet
- *** Centre of fresh air intake rear
- **** Centre of fresh air intake bottom

Convection

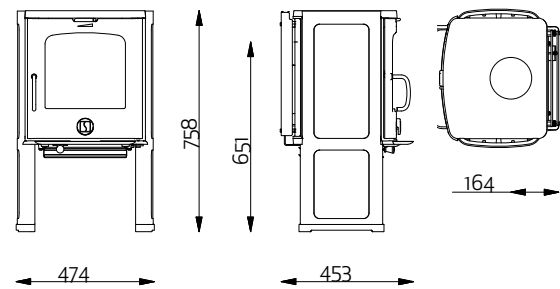

Soapstone

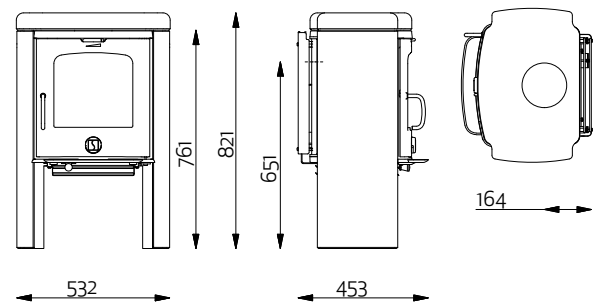

Scan Andersen 4-5 short leg version

Height 560 mm x Width 410 mm x Depth 453 mm

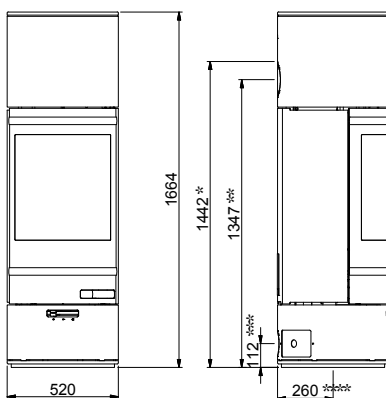

- * Height to the beginning of the connecting piece at top outlet
- ** Centre rear outlet
- *** Centre of fresh air intake rear
- **** Centre of fresh air intake bottom

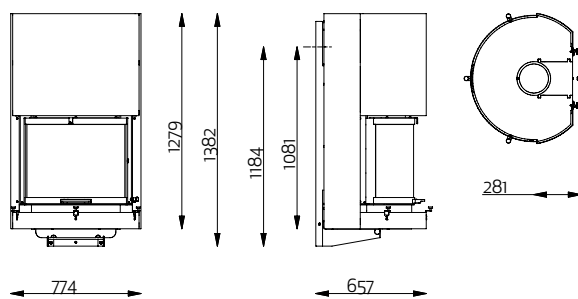
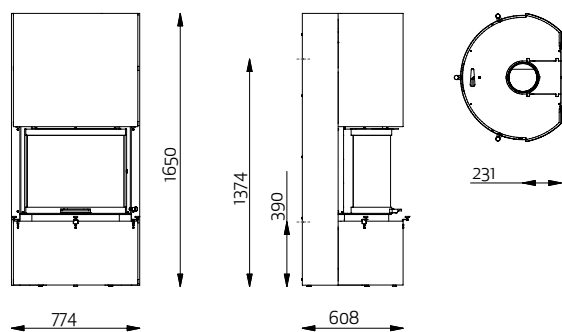

Convection model

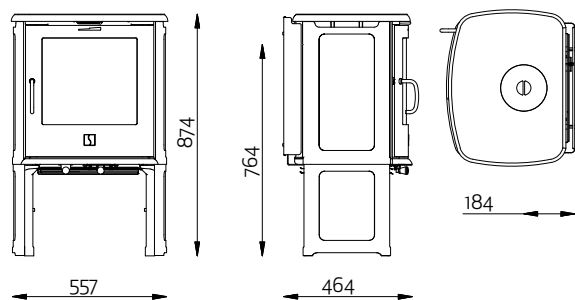

Soapstone model

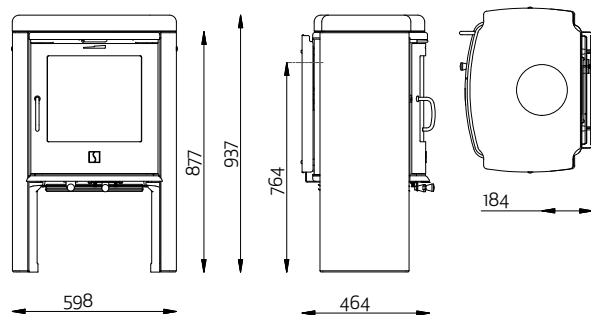

Scan Andersen 8-2 short leg version

Height 657mm x Width 454mm x Depth 473mm

Convection model

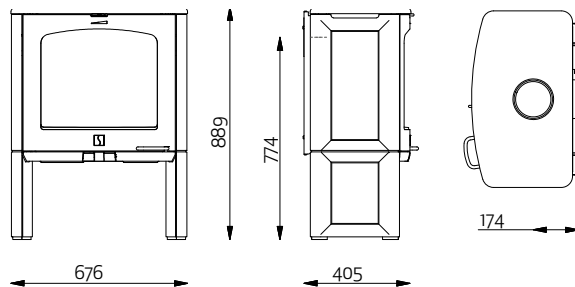

Soapstone model

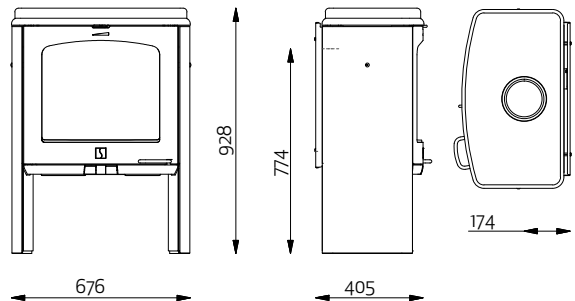

SCAN DSA 3-2/3-5

PAGE 38

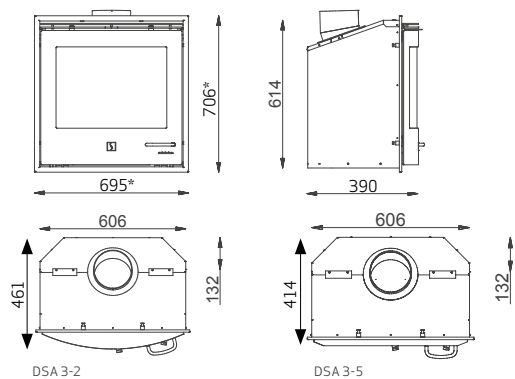

* Measurement includes UK standard 50 mm trim.

SCAN DSA 7-5

PAGE 38

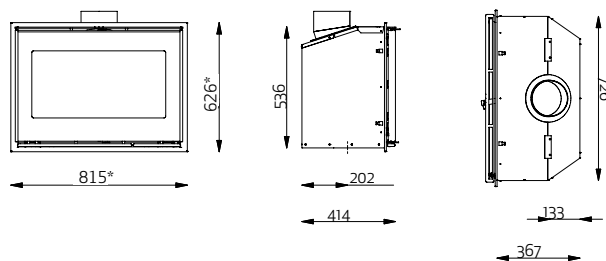

* Measurement includes UK standard 50 mm trim.

SCAN DSA 4-2/4-5

PAGE 38

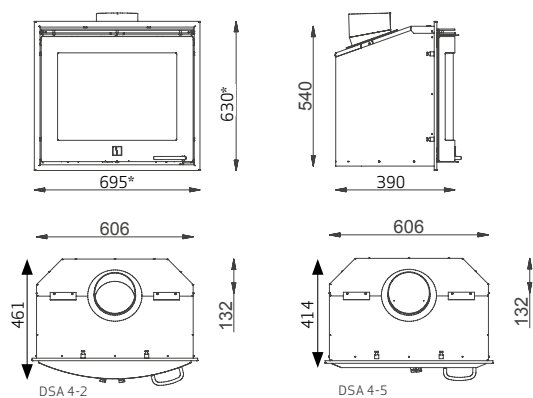

* Measurement includes UK standard 50 mm trim.

SCAN DSA 11

PAGE 40

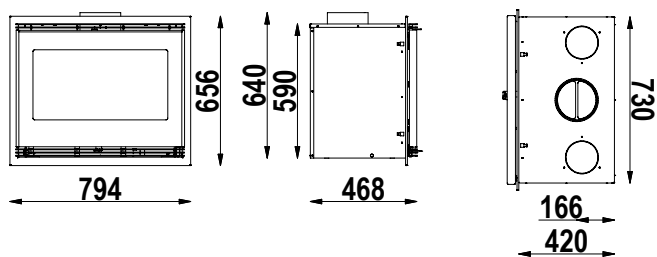

SCAN DSA 6

PAGE 38

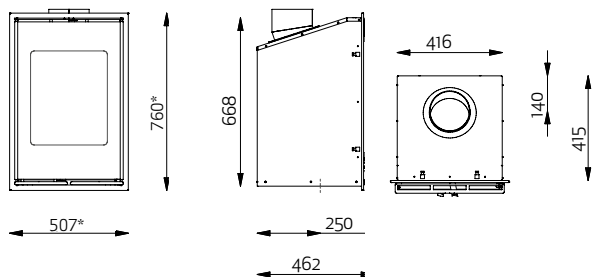

* Measurement includes UK standard 50 mm trim.

SCAN DSA 12

PAGE 40

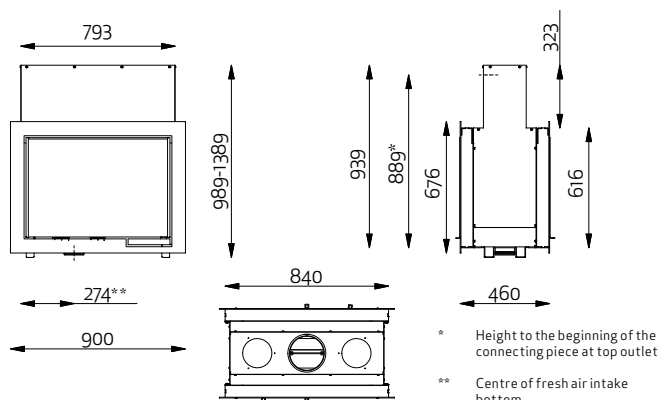

* Height to the beginning of the connecting piece at top outlet

** Centre of fresh air intake bottom

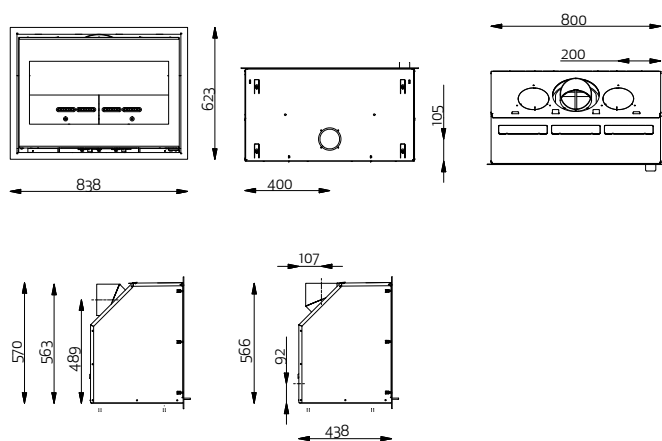
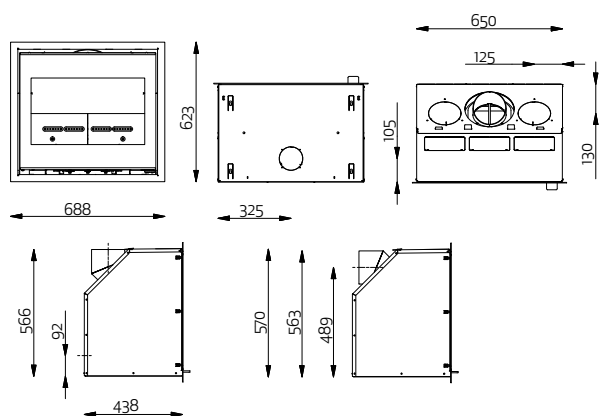



For us it is not just about warmth, but about delivering a perfect flame, enclosed in a design-conscious piece of furniture to suit the majority of homes.

Retailer info: