



## PRODUCTS



TIMELESS NORWEGIAN CRAFT







10 YEARS  
WARRANTY

## 10 YEARS – THE LONGEST WARRANTY ON THE MARKET

We wish to offer our customers the best of the best, and for this reason all products are handmade in Norway from the best available materials.

The exceptional durability is the reason that Jøtul offers a 10 year warranty - the longest on the market.

Read more about our warranty on page 53.



# TIMELESS NORWEGIAN CRAFT

Jøtul's cast iron wood stoves, fireplaces and inserts are hand made in Norway. Founded on a proud tradition, we have combined artistic and solid craftsmanship with the art of fighting off the cold for more than 160 years. This is the background for our current position as market leader and the preferred choice for customers who want the best all over the world.



## PURE HEAT FROM NORWAY

Norway is known around the world for their attitude towards sustainability and the environment and we have the strictest demands regarding emissions in the world. This is the reason why Jøtul perfects fuel utilisation and optimises the heating effect from their products at all times. This is good news for your wallet and the environment.

## CAST IRON – PREFERRED BY GENERATIONS

The choice to produce our products from cast iron is exclusively based on the material's extreme high quality and durability. Wood stoves from Jøtul do not deform, the doors stay in place and hinges and closing mechanisms remain reliable even after long-term load. In addition, spare parts extend further the longevity of a Jøtul product.



## AWARD-WINNING TIMELESS DESIGN

Products from Jøtul represent a functional, modern design. They are innovating, yet will stand the test of time beyond short-term trends. At Jøtul we are convinced that form should follow function and that good design is more than what meets the eye. Several of our products have received acknowledged design awards to support this statement.







**JØTUL F 305 SERIES - NEW**

# WATCH THE FLAMES

The philosophy behind Jøtul F 305 was to take an archetypal stove and perfect it down to the last detail. Our goal was to create a timeless wood stove with all the qualities of the traditional stoves pioneered by Jøtul. The result is an easy to use woodstove, focusing on functionality and heating capabilities, available in black paint or modern white enamel. Compared to traditional stoves, we have lifted the height of the burn chamber and the clean front design brings forward the flame from within.

Jøtul F 305 LL comes in black paint and white enamel. [EXPLORE THE ENTIRE SELECTION ON PAGE 16.](#)







**JØTUL F 480 SERIES - NEW**

# EASY TO POSITION

The Jøtul F 480 series is a round, fully cast iron, convection stove. This makes it ideal for positioning close to combustible walls and no firewall is required. The arched glass offers a great view to the fire. An integrated ash solution gives it a front with clean lines. This is one of the cleanest burning wood stoves ever produced.

EXPLORE THE ENTIRE SELECTION ON PAGE 18.















## JØTUL F 370 SERIES

# ENJOY THE HEAT FROM A MODERN CLASSIC

Jøtul F 373 is characterised by a timeless, award-winning design and it is one of the world's best-selling wood stoves. The combustion chamber is surrounded by glass windows for an optimal flame picture and it sits on a pedestal that may be rotated 360 degrees. This wood stove is the first and only in the world to have won the prestigious, international Red dot design award: best of the best. Jøtul F 373 WHE is a white stove that provides completely new possibilities. EXPLORE THE ENTIRE SELECTION ON PAGE 20.







## **JØTUL F 160 SERIES**

# TIGHT AND TIMELESS DESIGN

Jøtul F 163 is a small stove with glass on three sides. The modern, award-winning design has quickly become one of Jøtul's best sellers. With a smart air system controlled by only one valve it is simple to use. Optimal fuel use can be achieved on a relatively low burn rate.

EXPLORE THE ENTIRE SELECTION ON PAGE 24.











**JØTUL FS 74**

# EASY WITH ELEMENT FIREPLACE

Here you have the opportunity to achieve the same exclusive expression one gets with a brick fireplace, in a fraction of the time. Jøtul has a number of element fireplaces all of which can be built in a day. They require normally no reinforcement of the floors. Jøtul FS 74 is one of several available models.  
[READ MORE ABOUT IT ON PAGE 41.](#)





**JØTUL F 100**

## COMPACT AND PLACEMENT FRIENDLY

Jøtul F 100 is a compact stove with a great view of the fire. This stove is small enough to work even in the smallest of rooms while still being powerful enough to heat every corner. READ MORE ABOUT JØTUL F 100 ON PAGE 32.







## WATCH THE FLAMES

The Jøtul F 305 series consists of two models. The horizontal design makes it easy to position logs and it provides a rapid heat transfer to the room. Integrated convection reduces the distance to combustible materials at the rear. With Norwegian designers Anderssen & Voll, we have made a stove which merges 160 years of heating experience with timeless design. The fire is also raised to better enjoy the fire from the sofa.



**EFFICIENCY**  
79 %

**LOG SIZE**  
41 CM

**HEATING CAPACITY UP TO**  
145 M<sup>2</sup>

**ECO CERTIFIED**



## JØTUL F 305 LL - NEW



The Jøtul F 305 on legs has a light touch about it, focusing on showcasing the flames and the fire within. The horizontal format of the burn chamber makes it easy to burn large pieces of wood. Intuitive air controls makes it user friendly and the ash solution is easily accessible behind the front door.

EFFECT: min. 3.7 | max. 10.0 kW  
FLUE EXIT OPTIONS: Top and rear,  
Ø: 150 mm  
WEIGHT APPROX.: 143 kg  
DIMENSIONS, BASIC MODEL (HxWxD):  
850x560x420 mm

COLOURS:

- ☒ Black paint
- ☐ White enamel

ACCESSORIES: Floor plate in steel or glass,  
soap stone top, ash lip, outside air kit.

## JØTUL F 305 B - NEW



The Jøtul F 305 sits on a solid base and offers the possibility to store wood below the stoves firebox. The large door, which covers the ash solution, offers a great view to the fire.

EFFECT: min. 3.7 | max. 10.0 kW  
FLUE EXIT OPTIONS: Top and rear,  
Ø: 150 mm  
WEIGHT APPROX.: 167 kg  
DIMENSIONS, BASIC MODEL (HxWxD):  
850x560x420 mm

COLOURS:

- ☒ Black paint

ACCESSORIES: Floor plate in steel or glass,  
soap stone top, outside air kit.





---

” You have every reason to feel good when you are enjoying yourself in front of a fireplace from Jøtul. We are the top league in the world when it comes to environmentally friendly fireplace technology. Clean burn is a pleasure for us ”

---

## ACCESSORIES

---



### SOAP STONE TOP

To improve the heat storing capabilities of the Jøtul F 305, it is possible to add a thick, soap stone top. It measures 7 cm and adds another 35 kg of heat accumulating material to the stove, taking the total weight up to 178 kg. Cast Iron and soap stone have similar heat retaining capacities.

### SHAPED FLOOR PLATE

Floor plate follows the product's shape and allows you to install the product with the outside air through the floor.

## ANDERSSSEN & VOLL

---



Torbjørn Anderssen and Espen Voll were born respectively in Elverum, 1976 and in Trondheim, 1965.

They both come from creative upbringings; Torbjørn the son of a musician and a teacher and Espen the son of a ceramist and an architect.

After graduating from the Bergen Academy of Art and Design and the Oslo National Academy of Arts, they went on to cofounding the design group Norway Says in 2000. Norway Says were forerunners in a greater international orientation amongst Norwegian designers – at the same time drawing an international interest to the emerging, young design scene of Norway.

Norway Says culminated with the Söderbergs Award in 2007 and a 10 year retrospective exhibiton at the National Museum of Art, Architecture and Design in Oslo in 2009.

Anderssen & Voll was set up in 2009.

Their work spans from textile design through tableware, lighting and furniture to electronics for some of Europe's most renowned international Brands.

They have been absolute key in proposing what is known as New Nordic through their contributions for companies like Muuto, Kvadrat, Erik Jørgensen, Wrong for Hay, Jøtul, Røros Tweed and LK Hjelle. Their work also ressonates well with italian brands like Magis, Foscarini and Lapalma.

Working with the very different industrial cultures spanning from the mountains of Norway to the plains of Veneto is a continuous source of inspiration, so is the liberating possibilities of large scale industrial thinking.

Torbjørn Anderssen is professor at the Bergen Academy of Art and Design.





## SAFE WITHOUT FIREWALL

Jøtul F 260 and F 480-series consists of respectively 4 and 2 stoves. They are all convection stoves, with a lower surface heat, which makes it possible to put them close to combustible materials. The large glass offers a great view to the flames. The discrete designs are easily matched with any architectural style.



### JØTUL F 481 - NEW



The Jøtul F 481 has architectural, clean lines that follow the wood stove's shape all the way to the floor. There is practical storage space for accessories, so that you can keep the area around the stove clutter-free. The shelf in the base comes as standard, but may be removed if you so wish.

HEATING CAPACITY: Up to 143 m<sup>2</sup>  
EFFECT: min. 3.5 | max. 10.0 kW  
EFFICIENCY: 75 %  
LOG SIZE: 30 cm  
FLUE EXIT OPTIONS: Top and rear,  
Ø: 150 mm  
WEIGHT APPROX.: 198 kg  
DIMENSIONS, BASIC MODEL (HxWxD):  
1180x466x460 mm

#### COLOURS:

● Black paint



ACCESSORIES: Floor plate in steel or glass,  
kit for outside air.

### JØTUL F 483 - NEW



The Jøtul F 483 is characterised by Jøtul's bestselling signature design, where the wood stove sits on a pedestal. Top mounted with turntable (accessory) it is also possible to rotate the stove 360 degrees to enjoy the flames from several angles or locations in the room.

HEATING CAPACITY: Up to 143 m<sup>2</sup>  
EFFECT: min. 3.5 | max. 10.0 kW  
EFFICIENCY: 75 %  
LOG SIZE: 30 cm  
FLUE EXIT OPTIONS: Top and rear,  
Ø: 150 mm  
WEIGHT APPROX.: 186 kg  
DIMENSIONS, BASIC MODEL (HxWxD):  
1180x466x460 mm

#### COLOURS:

● Black paint



ACCESSORIES: Floor plate in steel or glass,  
kit for outside air.





## JØTUL F 262



Jøtul F 262 is delivered with a companion set hidden behind the base door as standard. The wood stove is a convection stove and is well suited for installation close to combustible material.

HEATING CAPACITY: 53 - 129 m<sup>2</sup>  
EFFECT: min. 3.7 | max. 9.0 kW  
EFFICIENCY: 83 %  
LOG SIZE: 33 cm  
FLUE EXIT OPTIONS: Top and rear,  
Ø: 150 mm  
WEIGHT APPROX.: 160 kg  
DIMENSIONS, BASIC MODEL (HxWxD):  
1087x519x491 mm



### COLOURS:

● Black paint

ACCESSORIES: Soap stone top, fan, external air connection set, glass or steel floor plate.

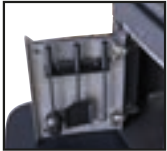

Practical **companion set** is standard for the Jøtul F 260 series. It is placed behind the base door and is easily available.

## JØTUL F 263



Jøtul F 263 has large side glass and comes with a companion set hidden behind the base door as standard. The wood stove is a convection stove and is well suited for installation close to combustible material.

HEATING CAPACITY: 53 - 129 m<sup>2</sup>  
EFFECT: min. 3.7 | max. 9.0 kW  
EFFICIENCY: 82 %  
LOG SIZE: 33 cm  
FLUE EXIT OPTIONS: Top and rear,  
Ø: 150 mm  
WEIGHT APPROX.: 160 kg  
DIMENSIONS, BASIC MODEL (HxWxD):  
1087x519x491 mm

### COLOURS:

● Black paint

ACCESSORIES: Soap stone top, fan, external air connection set, glass or steel floor plate.



## JØTUL F 262 S



Jøtul F 262 S has soap stone integrated in the design of the wood stove. The soap stone retains heat while the wood stove is in use and releases the heat slowly even after the fire is out. Comes with a companion set hidden behind the base door as standard.

HEATING CAPACITY: 53 - 129 m<sup>2</sup>  
EFFECT: min. 3.7 | max. 9.0 kW  
EFFICIENCY: 83 %  
LOG SIZE: 33 cm  
FLUE EXIT OPTIONS: Top and rear,  
Ø: 150 mm  
WEIGHT APPROX.: 240 kg  
DIMENSIONS, BASIC MODEL (HxWxD):  
1120x519x491 mm



### COLOURS:

● Black paint

ACCESSORIES: External air connection set, glass or steel floor plate.



The **fan** is installed in the base storage area space. It increases circulation of air around the fireplace, distributes the heated air around the room and provides a more even temperature. (Accessory)

## JØTUL F 263 S



In addition to large side glass, Jøtul F 263 S has large soap stone panels integrated in the design. They retain heat while the wood stove is in use and releases it slowly back into the room after the fire is out. Comes with a companion set hidden behind the base door as standard.

HEATING CAPACITY: 53 - 129 m<sup>2</sup>  
EFFECT: min. 3.7 | max. 9.0 kW  
EFFICIENCY: 82 %  
LOG SIZE: 33 cm  
FLUE EXIT OPTIONS: Top and rear,  
Ø: 150 mm  
WEIGHT APPROX.: 240 kg  
DIMENSIONS, BASIC MODEL (HxWxD):  
1120x519x491 mm

### COLOURS:

● Black paint

ACCESSORIES: External air connection set, glass or steel floor plate.





## INNOVATING SHAPES

The Jøtul F 370 series is a design award winning series of wood stoves and consists of ten main variants including a balanced flue gas model all with a unique cast iron design. Choose between different types of bases, materials and surfaces. Extra glass provides convection heating on the front as well and lower surface temperature on the entire wood stove. The standard colour for the entire series is black paint.



**EFFICIENCY**  
73 %

**LOG SIZE**  
30 CM

**HEATING CAPACITY**  
51 - 100 M<sup>2</sup>

**ECO CERTIFIED**



reddot design award  
winner 2011

### JØTUL F 371



The Jøtul F 371 is characterised by a base in a sleek design, clean lines and a practical shelf for storage in its base. It is also possible to install a cast iron door in the base in order to make the wood stove's appearance even neater.

EFFECT: min. 3.6 | max. 7.0 kW  
FLUE EXIT OPTIONS: Top and rear,  
Ø: 150 mm  
WEIGHT APPROX.: 163 kg  
DIMENSIONS, BASIC MODEL (HxWxD):  
1150x442x452 mm

COLOURS:

● Black paint

ACCESSORIES: Soap stone top, glass décor for the front, sides and top, removable shelf in the base, cast iron door for the base, glass or steel floor plate, external air connection.

### JØTUL F 371 HT



Jøtul F 371 HT has an open base with a practical storage space and a detachable shelf. This is a tall product where you can integrate hidden, heat accumulating stone. The wood stoves have a sleek and modern design.

EFFECT: min. 3.6 | max. 7.0 kW  
FLUE EXIT OPTIONS: Top and rear,  
Ø: 150 mm  
WEIGHT APPROX.: 200 kg  
DIMENSIONS, BASIC MODEL (HxWxD):  
1526x442x452 mm

COLOURS:

● Black paint

ACCESSORIES: Jøtul Heat Storage system, soap stone top, glass or steel floor plate, external air connection.





## JØTUL F 373



The Jøtul F 373 is characterised by its modern design where the combustion chamber sits on a pedestal. As the first and only wood stove in the world it has won the prestigious, international "Red dot design award: best of the best."

EFFECT: min. 3.6 | max. 7.0 kW  
FLUE EXIT OPTIONS: Top and rear,  
Ø: 150 mm  
WEIGHT APPROX.: 156 kg  
DIMENSIONS, BASIC MODEL (HxWxD):  
1150x442x452 mm

### COLOURS:

- Black paint
- White enamel
- Black enamel

ACCESSORIES: Convection set (not available for white enamel), turn plate, soap stone top, glass décor for the front, sides and top as well as glass or steel floor plate, external air connection.

Jøtul F 373 has received several design awards, "Red dot design award: best of the best" and "Award for design excellence" by Norsk Designråd.



reddot design award  
winner 2010



AWARD FOR DESIGN EXCELLENCE  
NORWEGIAN DESIGN COUNCIL

## JØTUL F 374



The Jøtul F 374 features an open base that provides room for a smart, customised wood basket on wheels underneath the wood stove. The basket can easily be carried outside to get new fire wood and has a hinged lid that ensures a tidy look.

EFFECT: min. 3.6 | max. 7.0 kW  
FLUE EXIT OPTIONS: Top and rear,  
Ø: 150 mm  
WEIGHT APPROX.: 154 kg  
DIMENSIONS, BASIC MODEL (HxWxD):  
1150x442x452 mm

### COLOURS:

- Black paint

ACCESSORIES: Customised wood basket with lid and wheels, soap stone top, glass décor for the front, sides and top, glass or steel floor plate, external air connection.





## JØTUL F 373 C



The Jøtul F 373 C is a convection wood stove which can be placed close to combustible material. The convection contributes to a reduced surface temperature so that it may be placed closer to the wall.

EFFECT: min. 3.6 | max. 7.0 kW  
FLUE EXIT OPTIONS: Top and rear,  
Ø: 150 mm  
WEIGHT APPROX.: 160 kg  
DIMENSIONS, BASIC MODEL (HxWxD):  
1172x482x484 mm

COLOURS:  
● Black paint

ACCESSORIES: Turn plate and glass or steel floor plate, external air connection.

## JØTUL F 375



Jøtul F 375 is characterised by straight lines and a base with storage space and a glass door. The base also features a space for storage and a detachable shelf.

EFFECT: min. 3.6 | max. 7.0 kW  
FLUE EXIT OPTIONS: Top and rear,  
Ø: 150 mm  
WEIGHT APPROX.: 165 kg  
DIMENSIONS, BASIC MODEL (HxWxD):  
1150x442x452 mm

COLOURS:  
● Black paint

ACCESSORIES: Soap stone top, glass décor for front, sides and top, floor plates in glass or steel, external air connection.

## JØTUL F 375 HT



Jøtul F 375 HT has an elegant glass door placed in front of the base storage which includes a detachable shelf. This is a tall product where you can integrate hidden, heat accumulating stone. The wood stoves has a sleek and modern design.

EFFECT: min. 3.6 | max. 7.0 kW  
FLUE EXIT OPTIONS: Top and rear,  
Ø: 150 mm  
WEIGHT APPROX.: 200 kg  
DIMENSIONS, BASIC MODEL (HxWxD):  
1526x442x452 mm

COLOURS:  
● Black paint

ACCESSORIES: Jøtul Heat Storage system, soap stone top, glass or steel floor plate, external air connection.

## JØTUL F 377



Jøtul F 377 includes elegant and heat-retaining décor from soap stone. It also features a practical storage space in the base with a detachable shelf for increased flexibility.

EFFECT: min. 3.6 | max. 7.0 kW  
FLUE EXIT OPTIONS: Top and rear,  
Ø: 150 mm  
WEIGHT APPROX.: 220 kg  
DIMENSIONS, BASIC MODEL (HxWxD):  
1172x494x489 mm

COLOURS:  
● Black paint

ACCESSORIES: Cast iron door for base, glass or steel floor plate, external air connection.



## JØTUL F 377 HT



Jøtul F 377 HT is a tall product made from cast iron and soap stone. It has an elegant and modern design where you can integrate hidden, heat accumulating stone.

EFFECT: min. 3.6 | max. 7.0 kW  
 FLUE EXIT OPTIONS: Top and rear,  
 Ø: 150 mm  
 WEIGHT APPROX.: 330 kg  
 DIMENSIONS, BASIC MODEL (HxWxD):  
 1551x494x489 mm

COLOURS:

● Black paint

ACCESSORIES: Jøtul Heat Storage system, cast iron door for base, glass or steel floor plate, external air connection.

## JØTUL HEAT STORAGE SYSTEM



Jøtul's Heat Storage System provides a great advantage with extra heat for up to 12 hours after the last log was put on the fire.

1. Air intake.
2. Secondary air for clean combustion ensures that gasses and particles in the smoke are transformed into heat.
3. Circulation of pre-heated air keeps the glass clean.
4. Stored heat is circulated and stored in the top of the stove when the air valve is closed.
5. The heat is released when the top air valve is open.

### Top air valve

Lighting a fire with the top air valve open provides rapid heating. When the valve is closed, the heating time may be prolonged by up to 12 hours.

## JØTUL HEAT STORAGE SYSTEM

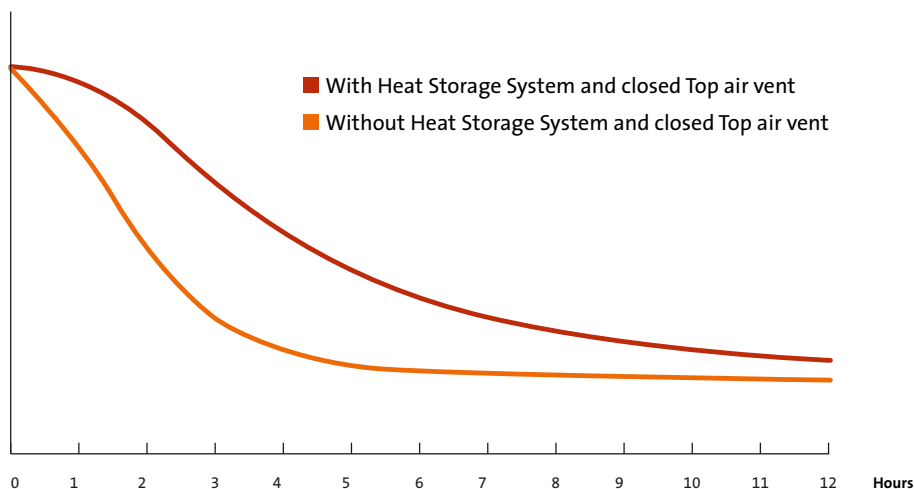

### Hidden heat storage

The material that we use, features extremely good properties for heat storage and in combination with the technical design, the product will give off maximum heat for a long period after the fire is out. The heat storage system is compact and hidden in the top of the wood stove where the heat retaining stones \* catches and stores the heat that is produced in the combustion chamber.

### Prolonged heating time

Jøtul's Heat Storage System can provide as much as 12 extra hours of heating time when the top air valve is closed. Read more on [jotul.com](http://jotul.com).

\* Only applicable when the heat accumulating stone (accessory) is added to HT elements.



## THE INTERIOR DESIGNERS FAVOURITE

The Jøtul F 160 series consists of six main models, with or without side glass and different bases. Parts of this series may be clad in soap stone for decoration and heat retaining properties. With soap stone the wood stove keeps more of the heat while the fire is going. It is adapted to modern houses and is suitable for low effect heating. This wood stove burns at an optimal level from 3.7 kW.



**EFFICIENCY**  
83 %

**LOG SIZE**  
33 CM

**HEATING CAPACITY**  
53 - 129 M<sup>2</sup>

**ECO CERTIFIED**



reddot design award  
winner 2011

### JØTUL F 162



Jøtul F 162 is characterised by its sleek look and three sturdy legs that give the wood stove an easy and modern look.

EFFECT: min. 3.7 | max. 9.0 kW  
FLUE EXIT OPTIONS: Top and rear,  
Ø: 150 mm  
WEIGHT APPROX.: 115 kg  
DIMENSIONS, BASIC MODEL (HxWxD):  
903x450x446 mm

COLOURS:

● Black paint

ACCESSORIES: Soap stone top, glass or steel floor plate, external air connection and cover for external air (matt black only), 100 mm short legs (BP only).

### JØTUL F 163



Jøtul F 163 features large side glass and three sturdy legs that give the stove an easy and modern look. Choose between black paint surface or maintenance free black or white enamel.

EFFECT: min. 3.7 | max. 9.0 kW  
FLUE EXIT OPTIONS: Top and rear,  
Ø: 150 mm  
WEIGHT APPROX.: 115 kg  
DIMENSIONS, BASIC MODEL (HxWxD):  
903x450x446 mm

COLOURS:

● Black paint  
○ White enamel  
● Black enamel

ACCESSORIES: Soap stone top, glass or steel floor plate, external air connection and cover for external air (matt black only), 100 mm short legs (BP only).





## JØTUL F 162 C



Jøtul F 162 C is one of the convection models in the series, which enables it to be placed close to combustible material in a room where there is no firewall.

EFFECT: min. 3.7 | max. 9.0 kW  
FLUE EXIT OPTIONS: Top and rear,  
Ø: 150 mm  
WEIGHT APPROX.: 134 kg  
DIMENSIONS, BASIC MODEL (HxWxD):  
948x473x475 mm

COLOURS:  
● Black paint

ACCESSORIES: Glass or steel floor plate,  
external air connection and cover for  
external air. 100 mm short legs (BP only).

## JØTUL F 163 C



Jøtul F 163 C has large side glass and three sturdy legs that give the wood stove a simple and modern look. This is a convection model in the series, which enables it to be placed close to combustible material in a room where there is no firewall.

EFFECT: min. 3.7 | max. 9.0 kW  
FLUE EXIT OPTIONS: Top and rear,  
Ø: 150 mm  
WEIGHT APPROX.: 134 kg  
DIMENSIONS, BASIC MODEL (HxWxD):  
948x473x475 mm

COLOURS:  
● Black paint

ACCESSORIES: Glass or steel floor plate,  
external air connection and cover for  
external air. 100 mm short legs (BP only).

## JØTUL F 164



Jøtul F 164 features a practical storage space in the base where you can hide fire accessories that often are just lying around. It is also possible to attach a hidden, customised companion set.

EFFECT: min. 3.7 | max. 9.0 kW  
FLUE EXIT OPTIONS: Top and rear,  
Ø: 150 mm  
WEIGHT APPROX.: 145 kg  
DIMENSIONS, BASIC MODEL (HxWxD):  
1033x450x447 mm

COLOURS:  
● Black paint

ACCESSORIES: Soap stone top, glass or steel  
floor plate, external air connection and  
companion set.

## JØTUL F 164 S



Jøtul F 164 S is characterised by the elegant sides and top made from soap stone, which not only makes the wood stove look beautiful, but also retains heat which is slowly released even after the fire is out. A practical storage space in the base cleverly hides accessories. It is also possible to install a hidden companion set which is custom-made for this model behind the base door.

EFFECT: min. 3.7 | max. 9.0 kW  
FLUE EXIT OPTIONS: Top and rear,  
Ø: 150 mm  
WEIGHT APPROX.: 225 kg  
DIMENSIONS, BASIC MODEL (HxWxD):  
1090x517x489 mm

COLOURS:  
● Black paint

ACCESSORIES: Soap stone top, steel or glass  
floor plate, external air connection and  
companion set.



## JØTUL F 165



Jøtul F 165 has large side glass and a practical storage space in the base where you can hide accessories that would otherwise just be lying around. You can also install a hidden, custom-made companion set.

EFFECT: min. 3.7 | max. 9.0 kW  
FLUE EXIT OPTIONS: Top and rear,  
Ø: 150 mm  
WEIGHT APPROX.: 145 kg  
DIMENSIONS, BASIC MODEL (HxWxD):  
1033x450x447 mm

COLOURS:  
● Black paint

ACCESSORIES: Soap stone top, glass or steel floor plate, external air connection and companion set.

## JØTUL F 165 S



Jøtul F 165 S has large side glass, heat retaining soap stone and a practical storage space in the base. While the wood stove is in use, the soap stone preserves heat which is slowly released into the room after the fire is out.

EFFECT: min. 3.7 | max. 9.0 kW  
FLUE EXIT OPTIONS: Top and rear,  
Ø: 150 mm  
WEIGHT APPROX.: 225 kg  
DIMENSIONS, BASIC MODEL (HxWxD):  
1090x517x489 mm

COLOURS:  
● Black paint

ACCESSORIES: Steel or glass floor plate, external air connection and companion set.

## COMPANION SET



Practical companion set is available as an accessory for models Jøtul F 164 and Jøtul F 165. It can be placed behind the base door and is easily available.

## SOAP STONE TOP PLATE



The Jøtul F 160 series offers soap stone top as a decorative element.



## JØTUL F 166



Jøtul F 166 has an elegant pedestal base which with time has become an award-winning signature design for Jøtul.

EFFECT: min. 3.7 | max. 9.0 kW  
FLUE EXIT OPTIONS: Top and rear,  
Ø: 150 mm  
WEIGHT APPROX.: 140 kg  
DIMENSIONS, BASIC MODEL (HxWxD):  
1033x450x447 mm

COLOURS:

● Black paint

ACCESSORIES: Soap stone top, glass or steel floor plate and external air connection.

## JØTUL F 167



Jøtul F 167 is characterised by large side glass and the pedestal base which with time has become an award-winning signature design for Jøtul.

EFFECT: min. 3.7 | max. 9.0 kW  
FLUE EXIT OPTIONS: Top and rear,  
Ø: 150 mm  
WEIGHT APPROX.: 140 kg  
DIMENSIONS, BASIC MODEL (HxWxD):  
1033x450x447 mm

COLOURS:

● Black paint

ACCESSORIES: Soap stone top, glass or steel floor plate and external air connection.

## JØTUL F 166 C



Jøtul F 166 C is an efficient convection wood stove featuring a sleek pedestal base. The convection panels enable you to place the product close to a combustible wall in a room where there is no firewall.

EFFECT: min. 3.7 | max. 9.0 kW  
FLUE EXIT OPTIONS: Top and rear,  
Ø: 150 mm  
WEIGHT APPROX.: 159 kg  
DIMENSIONS, BASIC MODEL (HxWxD):  
1078x473x476 mm

COLOURS:

● Black paint

ACCESSORIES: Glass or steel floor plate and external air connection.

## JØTUL F 167 C



Jøtul F 167 C is an efficient convection wood stove featuring large side glass. The convection panels enable you to place the product close to a combustible wall in a room where there is no firewall.

EFFECT: min. 3.7 | max. 9.0 kW  
FLUE EXIT OPTIONS: Top and rear,  
Ø: 150 mm  
WEIGHT APPROX.: 159 kg  
DIMENSIONS, BASIC MODEL (HxWxD):  
1078x473x476 mm

COLOURS:

● Black paint

ACCESSORIES: Glass or steel floor plate and external air connection.



## DESIGN CLASSICS

The design of the Jøtul F602 and Jøtul F118 are without doubt synonymous with the Jøtul brand. Taking their inspiration from traditional designs these models are fine pieces of heating furniture. Jøtul F602 can boast over 2 million units sold worldwide since its introduction.

### JØTUL F 602



Jøtul F 602 is one of Jøtul's timeless classics. Designed in the late 1930's by architects Blakstad and Munthe-Kaas and decorated by sculptor Ørnulf Bast. It has since gone through several technical upgrades and today it features modern and clean combustion. It is easy to place, offers efficient heating properties and comes with a practical cooking plate on the top. Available in clean burn or standard burn models.



HEATING CAPACITY: Up to 121 m<sup>2</sup>  
EFFECT: min. 2.3 | max. 8.5 kW  
EFFICIENCY: 74 %  
LOG SIZE : 40 cm  
FLUE EXIT OPTIONS: Top and rear, Ø: 125 mm  
WEIGHT APPROX.: 78 kg  
DIMENSIONS, BASIC MODEL (HxWxD):  
640x320x480 mm

#### COLOURS:

- Black paint
- Blue black enamel (clean burn only)

ACCESSORIES: 602 adaptor.



### JØTUL F 118



Jøtul F 118 is a timeless classic which has been upgraded by the inclusion of clean-burn technology and new details. It was designed in the late 1930's, amongst others by the famous artist Ørnulf Bast. The wood stove has a deep combustion chamber that caters to 60 cm logs and offers exceptionally long burn-time. On the top it has a practical cooking plate. The front of the wood stove is decorated with an ancient Norwegian prayer that was believed to keep the fire lit and the dark forces away from the house.



HEATING CAPACITY: Up to 157 m<sup>2</sup>  
EFFECT: min. 4.0 | max. 11.0 kW  
EFFICIENCY: 73 %  
LOG SIZE : 60 cm  
FLUE EXIT OPTIONS: Top, rear and sides, Ø: 115 mm  
WEIGHT APPROX.: 145 kg  
DIMENSIONS, BASIC MODEL (HxWxD):  
785x361x734 mm

#### COLOURS:

- Black paint

ACCESSORIES: Screen plate on the sides and on the back.



# CONSIDERATIONS WHEN INSTALLING A STOVE

## Heating effect and living area.

In order to get the most enjoyment from your stove, it is very important that the size is right for your living area and heating needs. If the stove is too big, you will constantly be using it shut down because you will not need the heat and end up with soot on the glass and in your chimney because it is not being run hot enough. (Please see the information on our clean-burn system.) If the wood stove is too small, it will be over fired and its lifetime will be considerably reduced due to the excessive heat.

The dealer needs information about living area and type of insulation in your home in order to give you good advice. Normally, the need for heating in UK homes is about 1 kilowatt for every 14 cubic metres. To work out your requirements, multiply your room width and length measured in metres, by your room height in metres (i.e. 5m x 7m = 35 x 2.5m = 87.50. This means that your room, with a normal sized window and number of doors, has a volume of 87.5 cubic metres and will need approximately a  $(87.5 \div 14)$  6 kW Jøtul stove. This can be reduced or increased by type of insulation, the number of windows, ceiling height and so on.

## Ventilation

In order to function properly, the stove needs air. The chimney pulls air through the stove, but if your house is very well sealed and insulated, or if mechanical ventilation is fighting the natural draught in the chimney, you can experience problems with the function of the stove. The recommended solution is to connect so-called “outside air” or “closed combustion” to the stove. If you live in a house with new and tight insulation or have mechanical extraction, it is important that you consider this when you plan the installation of your stove.

Talking to professionals from our network of dealers early on, can save you both time and money. They can give you useful advice that is fit for your needs, your living situation and of course, your budget. Here are some issues that you should think through or investigate before you start the process of buying a new stove. They are relevant whether you go to one of Jøtul’s network of dealers or if you want to do most of the work yourself (subject to planning permission).

## Window glass and insulation

Old and draughty houses with poor insulation need considerably more heating than houses with proper insulation and triple glazed windows. The scope of the heat loss in your home is something that you know best, but if you reside in a low energy house or a newer house, it is important to choose a stove that works well on low effect. Jøtul F 160 and F 260 series are great examples of these types of wood stoves – they burn optimally even at 3kW.

## Chimney

Most problems with stoves stem from the chimney being incorrectly dimensioned or not working properly. In order for a stove to work optimally, a chimney with an internal diameter that is bigger than the flue outlet on the stove should be attached. In the installation and user guides you find information about the necessary draught for the different products to function optimally.

A rule of thumb is that 1 metre of chimney creates 4 Pascal of draught. Few stoves can function on less than 12 Pascal. Sharp bends on the flue outlet reduces the draught. If you are unsure about how your chimney works, the Jøtul retailer or the chimney sweep association can help you. You can also get help to renovate or line your old chimney or alternatively install a steel chimney.

Steel chimneys are reasonably priced and a satisfactory alternative to the traditional brick chimney.

## Where the stove should be installed

Different stoves have different features. Some are designed to be placed close to flammable material, while others require a fireproof barrier in order to be placed close to the wall. A drawing that shows where the stove should be placed in relation to the chimney outlet, fireproof wall and furniture will be of great help when you seek advice with the experts.

## Suitable hearth requirements.

Most of Jøtul’s wood stoves are tested to EN 13240, part of which requires that the stove does not increase the temperature of the hearth the stoves is sited on above 100 degrees centigrade.

Current UK building regulations state that if an appliance does not raise hearth temperature above 100 degrees centigrade then the hearth does not need to be constructional and a supplementary hearth may be used. Your Jøtul dealer or local building control officer should be consulted for clarification and further instruction.

## Installation

In the UK the installation should be carried out by a HETAS registered installer.







## JØTUL F 500

# HOT, VERY HOT!

Jøtul F 500 is a sturdy stove that delivers a lot of heat. It holds up to 55 cm long logs that can be loaded either through the front door, or through a practical door on the side of the stove. The entire stove is made of cast iron, ensuring good function during a long life. [READ MORE INFORMATION ON THE F 500 ON PAGE 33.](#)







## JØTUL F 100 / JØTUL F 100 SE



Jøtul F 100 is a compact wood stove with capacity for logs size up to 40 cm. It has a small internal ash removal solution that makes removing the ashes an easy job (multifuel version only).

The wood stove has a large glass door providing a great view of the burning logs and is characterised by a traditional pattern used in Norwegian craft work.



HEATING CAPACITY: Up to 107 m<sup>2</sup>  
EFFECT: min. 2.7 | max. 7.5 kW  
EFFICIENCY: 78 %  
LOG SIZE : 40 cm  
FLUE EXIT OPTIONS: Top and rear, Ø: 150 mm  
WEIGHT APPROX.: 97 kg  
DIMENSIONS, BASIC MODEL (HxWxD):  
570x528x336 mm

### COLOURS:

- Black paint
- Blue black enamel (multifuel only)

ACCESSORIES: Long legs (215 mm),  
Rear heat shield.



## JØTUL F 8 TD



We wanted a classic, elegant look when we designed the Jøtul F 8. One that would complement any interior decor. Inspired by North American classic colonial design we created a stove beautiful enough to become a cherished piece of furniture.

HEATING CAPACITY: Up to 135 m<sup>2</sup>  
EFFECT: nom. 8.0 kW  
EFFICIENCY: 75 %  
LOG SIZE : 46 cm  
FLUE EXIT OPTIONS: Top and rear, Ø: 150 mm  
WEIGHT APPROX.: 143 kg  
DIMENSIONS, BASIC MODEL (HxWxD):  
760x666x430 mm

### COLOURS:

- Black paint

## JØTUL F 400



Jøtul F 400 is a large wood stove, with room for logs of up to 50 cm. This model has a large external ash removal solution which facilitates convenient emptying of the ashes. A practical ash lip catches ashes and sparks. Options: Plain door - black paint only.

HEATING CAPACITY: Up to 150 m<sup>2</sup>  
EFFECT: min. 3.9 | max. 10.5 kW  
EFFICIENCY: 84 %  
LOG SIZE : 50 cm  
FLUE EXIT OPTIONS: Top and rear, Ø: 150 mm  
WEIGHT APPROX.: 158 kg  
DIMENSIONS, BASIC MODEL (HxWxD):  
744x670x597 mm

### COLOURS:

- Black paint
- Blue black enamel
- Brown majolica enamel
- Ivory enamel

ACCESSORIES: External air connection,  
80 mm short legs.

Also available in Gas



## JØTUL F 400 SE



The Jøtul F 400 Special Edition has the same characteristics as the standard F 400, but the Jøtul signature arches in the doors have been removed to improve the view to the fire.

HEATING CAPACITY: Up to 150 m<sup>2</sup>  
EFFECT: min. 3.9 | max. 10.5 kW  
EFFICIENCY: 84 %  
LOG SIZE : 50 cm  
FLUE EXIT OPTIONS: Top and rear, Ø: 150 mm  
WEIGHT APPROX.: 158 kg  
DIMENSIONS, BASIC MODEL (HxWxD):  
744x670x597 mm

### COLOURS:

- Black paint

ACCESSORIES: External air connection,  
80 mm short legs.





## JØTUL F 500 AND JØTUL F 500 SE







The Jøtul F 500 has one of the largest styled doors available, which allows for an unbridled view of the flame picture through timeless 'gothic' design. Side and front door loading options allow for the stove to be positioned in a multitude of settings. At 9 kW rated heat output, the Jøtul F 500 is large enough to be the primary heat source in most homes.



HEATING CAPACITY: Up to 157 m<sup>2</sup>  
 EFFECT: min. 4.0 | max. 11.0 kW  
 EFFICIENCY: 78 %  
 LOG SIZE : 55 cm  
 FLUE EXIT OPTIONS: Top and rear, Ø: 150 mm  
 WEIGHT APPROX.: 200 kg  
 DIMENSIONS, BASIC MODEL (HxWxD):  
 715x720x420 mm



### COLOURS:

-  Black paint
-  Blue black enamel
-  Brown majolica enamel
-  Ivory enamel

ACCESSORIES: 80 mm External air connection.





## JØTUL F 600



With all of the technological features of its smaller cousins, the Jøtul F 600 is indeed a classic wood stove. It is designed to have room for considerable sized logs and has a large firebox volume to heat much larger rooms. Bigger is definitely best. In addition, it is superbly crafted with a side-loading door for added convenience and an easily accessed ash pan.

HEATING CAPACITY: Up to 170 m<sup>2</sup>  
 EFFECT: min. 4.0 | max. 12.0 kW  
 EFFICIENCY: 78 %  
 LOG SIZE: 55 cm  
 FLUE EXIT OPTIONS: Top and rear, Ø: 150 mm  
 WEIGHT APPROX.: 200 kg  
 DIMENSIONS, BASIC MODEL (HxWxD):  
 800x733x410 mm

### COLOURS:

-  Black paint
-  Blue black enamel
-  Brown majolica enamel
-  Ivory enamel

ACCESSORIES: 100 mm External air connection.





## FUNCTIONAL ELEGANCE

This group of freestanding stoves has over the years gained a reputation as one of the best on the market, if you're concerned with warmth, quality and longevity. Here you will find both small and large stoves, which means that you can always find one that suits your needs. They are easy to use and have a very broad output range, which means that they work equally well on a mild autumn evening as on a cold winter day.

**EFFICIENCY**  
78 %

**LOG SIZE**  
40 CM

**HEATING CAPACITY UP TO**  
129 M<sup>2</sup>

**ECO CERTIFIED**



### JØTUL F 3



Also available in Gas

Jøtul F 3 has a horizontal format which provides a spacious combustion chamber for larger logs. The glass door provides a perfect view of the burning logs. An external ash removal solution ensures easy ash removal. A practical ash lip catches sparks or ashes in an efficient way.

EFFECT: min. 3.4 | max. 9.0 kW  
FLUE EXIT OPTIONS: Top, rear and sides,  
Ø: 150 mm  
WEIGHT APPROX.: 124 kg  
DIMENSIONS, BASIC MODEL (HxWxD):  
707x577x484 mm

**COLOURS:**

- ☒ Black paint
- ☒ Blue black enamel
- ☒ Brown majolica enamel
- ☐ Ivory enamel

ACCESSORIES: Fire screen, extra convection plate on the back, decorative ring for top mounting (Jøtul F 3 CB only).

### JØTUL F 3 TD / MF 3



The F3 TD is a design classic. A dedicated wood stove available in black paint finish only. Enhancing any room with its presence, this really is a piece of furniture as well as a great source of heat.

Jøtul MF 3 is a true multi-fuel version of the iconic Jøtul F 3. The plain door gives an uninterrupted view of the fire. With primary air control on the ash pan door and secondary air via the control at the top of the stove, user friendliness comes as standard. Comes complete with an easy to remove bottom grate.

EFFECT: min. 3.4 | max. 9.0 kW  
FLUE EXIT OPTIONS: Top, rear and sides,  
Ø: 150 mm  
WEIGHT APPROX.: 124 kg  
DIMENSIONS, BASIC MODEL (HxWxD):  
707x577x484 mm

**COLOURS:**

- ☒ Black paint



ACCESSORIES: Fire screen, extra convection plate on the back.





# PURE JOY IN FRONT OF THE FIRE

Jøtul wood stoves and fireplaces are manufactured in Norway where they are subjected to some of the strictest regulations regarding the environmental world. The main ingredient is recycled cast iron. Wood is a renewable resource and a CO<sub>2</sub> neutral source of energy that does not contribute to the greenhouse effect.

Modern, clean burning wood stoves reduce emissions of particles by up to 90 % compared with older fireplaces.

## Clean heating with CO<sub>2</sub> neutral products

A Jøtul product is amongst the cleanest products available on the market, so you can light your fire and feel good about it. Wood is a renewable resource and the combustion in a clean-burning wood stove is so efficient that you do not contribute to the greenhouse effect. The explanation is that the CO<sub>2</sub> that is produced during combustion does not exceed the amount that is absorbed when a new tree is planted and grows back. A clean-burning product also provides maximum utilisation of the energy in the wood and emits a minimum of particles. The Jøtul production takes place with a focus on both the internal and the external environment. This is your guarantee that there are no toxic heavy metals in the surface treatment and at production Jøtul is subjected to strict requirements regarding emissions. You have every reason to feel good when you relax in front of a fireplace from Jøtul. Our objective is to be at the global forefront regarding environmentally friendly fireplace technology. Hence, clean combustion is matter of fact to us. It is economical to be environmentally friendly. Jøtul's clean-burning fireplaces need significantly less wood than older, non clean-burning fireplaces to produce

the same amount of heat. If you use it correctly, this could mean as much as half of the wood consumption. You get maximum heat from burning wood without harming the environment and you save money due to lower wood consumption.

## What do we mean by clean-burning?

Clean-burning means that the fireplace has a double combustion system that utilises the wood fuel in an optimal way and keeps pollution at an extremely low level. In this way, we achieve minimal smoke emissions because the fireplace utilises the energy in order to produce heat instead of smoke. Because the clean-burn system will only work when the firebox temperature reaches 350 degrees C, it is important to run your stove correctly, by using a small amount of fuel, often. If a stove is loaded up and shut down without reaching this temperature, then the moisture in the wood will condense and lead to chimney problems and blackening of the glass. A non clean-burn stove can be shut down more, but this leads to far greater emissions leaving the chimney, which in turn leads to more pollution in the atmosphere.

## Recycling of cast iron

Jøtul has a strong commitment to research and development in order to have the cleanest possible production. Fireplaces from Jøtul are being produced at one of the cleanest and most modern foundries in the world. The raw materials are based on recycling of iron. Fireplaces from Jøtul are made of iron that has been melted down and recast again.

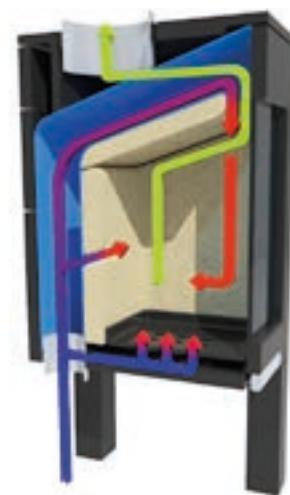



## CLEAN & INSTANT

Jøtul gas products offer an alternative to their wood burning cousins, still offering the same aesthetics and high standard of build quality but in a clean and convenient fuel option.

### JØTUL GF 300 BF/CF



The Jøtul GF 300 BF/CF is available as balanced or convectional flue. Its contemporary lines and arch double doors frame a hand crafted log set, flame and glowing embers with realism unrivalled in the fireplace history.

HEAT OUTPUT KW: NG 5.2 / LPG 5.4  
HEAT INPUT KW: NG 6.8 / LPG 6.9  
EFFICIENCY: 80.6 % CF & 76.6 % BF  
FUEL EFFECT : Log  
GAS TYPES : NG / LPG  
FLUE EXIT OPTIONS: Top and rear, Ø: 125 mm  
FLUE SIZE: 125 mm  
DIMENSIONS, BASIC MODEL (HxWxD):  
700x565x330 mm

#### COLOURS:

- ☒ Black paint
- ☒ Blue black enamel
- ☒ Brown majolica enamel
- ☐ Ivory enamel

### JØTUL GF 400 CF



The Jøtul GF 400 CF presents the perfect union of high efficiency and cast iron beauty. Its classic lines and Gothic arch double doors, frame a hand crafted log set. Complete with flames and glowing embers that give the Jøtul GF 400 CF unrivalled realism within the stove industry.

HEAT OUTPUT KW: NG 6.8 / LPG 7.2  
HEAT INPUT KW: NG 8.7 / LPG 9.3  
EFFICIENCY: 77.9 %  
FUEL EFFECT : Log  
GAS TYPES : NG / LPG  
FLUE EXIT OPTIONS: Top and rear, Ø: 125 mm  
FLUE SIZE: 125 mm  
DIMENSIONS, BASIC MODEL (HxWxD):  
711x673x609 mm

#### COLOURS:

- ☒ Black paint
- ☒ Blue black enamel
- ☒ Brown majolica enamel
- ☐ Ivory enamel





## JØTUL GF 373 BF



Modern design with an elegant three-sided fire view, the Jøtul GF 373 BF utilises the new Jøtul Burner III to create an exceptional fire view from any angle. Based on the award winning Jøtul F 370 wood stove, the Jøtul GF 373 BF offers the same contemporary cast iron styling in a freestanding balanced flue stove complete with log fuel effect. The Jøtul GF 373 BF is the perfect combination of design and craftsmanship.

HEAT OUTPUT KW: NG 5.7 / LPG 5.5

HEAT INPUT KW: NG 6.9 / LPG 7.0

EFFICIENCY: 78.4 % (LPG) 82.2 % (NG)

FUEL EFFECT: Log

GAS TYPES: NG / LPG

FLUE EXIT OPTIONS: Top, Ø: 150 mm

FLUE SIZE: 150/170 mm

DIMENSIONS, BASIC MODEL (HxWxD):

1150x442x452 mm

COLOURS:



Black paint



White enamel

## GAS, CLEAN & CONVENIENT

Jøtul gas products offer quick and efficient heating. The range consists of classic and modern gas stoves in balanced and conventional flue versions and all with the same high standard of finish and cast iron as found on our wood burning products. Gas allows instant heat without any preparation or cleaning, after a long day at work your room can have a glow within seconds of arriving home.

Conventional flue appliances work by utilising your lined chimney or a prefabricated twin wall system whilst if this is not practical balanced flue is an option venting the stove vertically through a roof or horizontally through an adjacent wall.

Jøtul gas appliances are made with top quality recycled cast iron produced by our foundry in Norway. The technology and manufacturer of the finished products is at Jøtul North America, Portland, Maine where they have been pioneers in gas fire technology for the last 15 years and whose innovation include the trademarked Jøtul Heat fin and Jøtul burner system.

Before you consult your Jøtul dealer determine how large your room is in cubic metres, determine where you would like to site the appliance, do you have a chimney or adjacent wall? Where is your nearest gas point and have you an air brick in the room if you require a conventional flue product greater than 7.0 kW input.





**JØTUL S 70 SERIES - NEW**

# INSTALLS DIRECTLY AGAINST A COMBUSTIBLE WALL

Jøtul S 71/ Jøtul S 72 is supplied with an integrated firewall and can be mounted directly against a combustible wall. It is made for corner installations and offers a great view of the fire. A soap stone shelf is standard. The insert is the bestselling Jøtul I 520, which offers glass on two sides and a state of the art combustion.









## EASY WITH ELEMENT FIREPLACE

Here you have the opportunity to achieve the same exclusive expression one gets with a bricked fireplace, in a fraction of the time. Jøtul has a number of element fireplaces all of which can be built in a day. They require normally no reinforcement of the floors. For more information on how to build a fireplace, see page 52.



### JØTUL S 71 FR - NEW



Jøtul S 71 is made for Jøtul I 520 FR, which has glass in the front and on the right side of the insert. The light concrete elements are easy to build and the integrated firewall makes expensive wall insulation unnecessary.

WEIGHT APPROX.: 402 kg  
DIMENSIONS, BASIC MODEL (HxWxD):  
1700x1065x685 mm  
TECHNICALLY DATA:  
See Jøtul I 520 Insert, page 44

COLOURS:

● Black paint/lightweight concrete

ACCESSORIES: Floor plates in steel or glass, outside air connection, adapter for ventilated chimney.

### JØTUL S 72 FL - NEW



Jøtul S 72 is made for Jøtul I 520 FL, which has a glass front and glass on the left hand side of the insert. As with the S 71, the firewall is included in the product.

WEIGHT APPROX.: 402 kg  
DIMENSIONS, BASIC MODEL (HxWxD):  
1700x1065x685 mm  
TECHNICALLY DATA:  
See Jøtul I 520 Insert, page 44

COLOURS:

● Black paint/lightweight concrete

ACCESSORIES: Floor plates in steel or glass, outside air connection, adapter for ventilated chimney.





## JØTUL FS 73 / FS 74



Jøtul FS 73 and FS 74 are adapted to the insert Jøtul I 520 and have access to fire from three sides. They have a convenient storage at the base.

If you want a very clean design this can be closed when setting up the fireplace. Jøtul FS 74 has an integrated firewall and can be mounted directly to combustible materials.

TOTAL WEIGHT APPROX.: 221/ 241 kg without stove

DIMENSIONS, BASIC MODEL (HxWxD):

1690x574x530 mm (Jøtul FS 73)

1690x574x600 mm (Jøtul FS 74)

TECHNICALLY DATA:

See Jøtul I 520 Insert, page 44

COLOURS:

● Black paint/lightweight concrete

ACCESSORIES: Steel floorplate

## JØTUL FS 91 / 92



Jøtul FS 91 and Jøtul FS 92 are flush with the large, arched glass door that provides the perfect view of the burning logs. The result is a fireplace with a slim and round shape. These fireplaces house the Jøtul F480 firebox.

EFFECT: min. 3.5 | max. 10.0 kW

LOG SIZE : 30 cm

FLUE EXIT OPTIONS: Top and rear, Ø: 150 mm

TOTAL WEIGHT APPROX.: 281 kg without stove

DIMENSIONS, BASIC MODEL (HxWxD):

1570x525x480 mm

COLOURS:

● Black paint/lightweight concrete/Olivine

ACCESSORIES: Glass floor plate, black glass decorative plate (Jøtul FS 92, external air kit).

## INFO



Jøtul FS 91 offers smooth sides that are flush with the large arched glass door in the Jøtul F 480 firebox.



Jøtul FS 92 has Art Deco style cut-outs on the sides. Tinted glass may be installed on the sides of the fireplace as an accessory.







## JØTUL I 400 HARMONY

# A FLEXIBLE SERIES OF INSERTS

Jøtul I 400 Harmony is a medium-sized fireplace insert with a modern design. It features a large, foldable glass door for a perfect view of the burning logs. It has light coloured burn plates that makes the fireplace insert look light and attractive even when you don't have the fire lit.

READ MORE ABOUT THE JØTUL I 400 HARMONY ON PAGE 45.





## INSERTS

Jøtul's fireplace inserts are used to customise a fireplace, or they are included in factory assembled surrounds. When you choose to build a fireplace, it is a choice that you will have to live with for a long time. Hence, Jøtul focuses on a timeless design so that the insert is included as a natural part of the architecture in the room where it is placed. Cast iron inserts last for a very long time and do not degrade, so the doors, hinges and closing mechanisms remain reliable even after being exposed to long-term usage. This is important when building a fireplace that you want to have for a long time.



## JØTUL I 520



Jøtul I 520 F



Jøtul I 520 FRL



Jøtul I 520 FR



Jøtul I 520 FL

The Jøtul I 520 series is a flexible insert system that consists of four inserts. You can choose whether you want glass on one, two or three sides. The design is timeless and the construction optimal and futuristic. Jøtul I 520 has enamelled burn plates which provide a light and airy flame picture. All glass has a heat-reflecting surface that ensures cleaner glass and better combustion. Even though the insert is large, it works well even at 3.9 kW effect.

HEATING CAPACITY: Up to 143 m<sup>2</sup>

EFFECT: min. 3.9 | max. 10.0 kW

EFFICIENCY: 77 %

LOG SIZE: 40 cm

FLUE EXIT OPTIONS: Top and rear, Ø: 150 mm

WEIGHT APPROX.: 110kg

DIMENSIONS, BASIC MODEL (HxWxD):

524x670x431 mm

COLOURS:

● Black paint

ACCESSORIES: Complete leg stand, door lock left, broad frames, cassette grids, external air connection and complete convection top.





## JØTUL I 18



Jøtul I 18 Panorama is a large insert in a contemporary design with large curved glass which offers a superb view of the logs burning. Jøtul I 18 Harmony is a large insert in a contemporary design with bi-folding doors glass which offers a superb view of the logs burning. With a canopy, they become an ideal and impressive inglenook appliance. It can be installed free-standing by the adaption of the supporting legs provided or with a matching curved base.

EFFECT: min. 3.0 | max.15.0 kW

EFFICIENCY: 81 %

LOG SIZE : 50 cm

FLUE EXIT OPTIONS: Top, Ø: 175/200 mm

WEIGHT APPROX.: 186 kg

BASIC DIMENSIONS, BURN CHAMBER (HxWxD):

597x746x600 mm

COLOURS:

● Blue black enamel

ACCESSORIES: Canopy, Firescreen (panorama model only), Side Extension Panel, Top Extension Panel, Internal Ash Solution, Decorative Plinth

## JØTUL I 400 HARMONY



The Jøtul I 400 series offers modern design and technology. Jøtul I 400 Flat has a flat front and Jøtul I 400 Panorama has arched glass and both offer a great view of the burning logs. Jøtul I 400 Harmony has two doors that can be folded to the side to offer the open fireplace feeling.

HEATING CAPACITY: Up to 129 m<sup>2</sup>

EFFECT: min. 3.7 | max. 9.0 kW

EFFICIENCY: 74 %

LOG SIZE : 40 cm

FLUE EXIT OPTIONS: Top, Ø: 150 mm

WEIGHT APPROX.: 125 kg

BASIC DIMENSIONS, BURN CHAMBER (HxWxD):

492 or 514 bi-fold version x640x422 mm

COLOURS:

● Black paint

ACCESSORIES: External air kit, installation kit for cassette, ash solution, grid, flat smoke bell and decorative leg cover.



## JØTUL I 80 RH HARMONY



The Jøtul I 80 RH with 'Harmony' doors has the Jøtul airwash system as standard.

EFFECT: min. 2.0 | max.10.0 kW

EFFICIENCY: 74 %

LOG SIZE : 40 cm

FLUE EXIT OPTIONS: Top, Ø: 150/175 mm

WEIGHT APPROX.: 132 kg

BASIC DIMENSIONS, BURN CHAMBER (HxWxD):

569x630x524 mm

COLOURS:

● Black paint

ACCESSORIES: Canopy, Decorative Plinth





## JØTUL CASSETTES

The landscape 'air washed' doors on the Jøtul Cassettes not only give a wonderful view of the fire; they are the central features of these built in fireplaces. Ideally sized to fit most conventional fireplace openings, the Jøtul Cassettes offer convected heat circulation to reach out to the corners of your room. Capable of producing up to an impressive 12 kW heat output, the Jøtul Cassettes give you the pleasures of traditional home heating combined with an astounding fire view.

### JØTUL C 24



The Jøtul C 24 cassette offers one of the world's largest views to the fire, compared to the size of the cassette. The clean design makes it suitable for any interior style. The burn chamber itself is surrounded by a convection box, making it ideal for transforming old, open fireplaces into modern and efficient closed combustion systems, whilst respecting the need to still have a great view to the fire.

HEATING CAPACITY: Up to 143 m<sup>2</sup>  
 EFFECT: min. 4.0 | max. 10.0 kW  
 EFFICIENCY: 78 %  
 FLUE EXIT OPTIONS: Top, Ø: 150/175 mm  
 LOG SIZE: 50 cm  
 WEIGHT APPROX.: 136 kg  
 BASIC DIMENSIONS, BURN CHAMBER (HxWxD):  
 556/715/441 mm

#### COLOURS:

● Black paint

ACCESSORIES: Tangential fan, Kit for outside air, set of convection adaptors.

### JØTUL C 31/33



The Jøtul C 31/33 cassettes offers a landscape view of a beautiful solid fuel burning insert in it's own convection box and is ideally sized to fit most conventional fireplace openings. The Jøtul Cassettes give you the pleasure of a traditional home heating combined with an astounding fire view.

EFFECT: min. 2.0 | max. 10.0 kW  
 EFFICIENCY: 73 %  
 FLUE EXIT OPTIONS: Top, Ø: 150/175 mm  
 LOG SIZE: 55 cm  
 WEIGHT APPROX.: 143 kg  
 BASIC DIMENSIONS, BURN CHAMBER (HxWxD):  
 570x730x400 mm / 570x730x400 mm

#### COLOURS:

● Blue black enamel

ACCESSORIES: Flue Connector Kit.





## FLUE PIPES

---



We offer a wide variety of flue pipes in both painted and enamel finishes, both of the highest quality.

## FLOOR PLATES

---



We have a wide selection of floor plates of different materials, shapes and colours.

## COMPANION SETS

---



We offer a wide range of functional companion sets in a contemporary design.

## WOOD BASKET

---



Wood baskets come in a wide range and different sizes, materials and colours.





## NO PATIO WITHOUT A FIREPLACE

In cooperation with Hareide Design, we developed the Jøtul Terrazza. This is an outdoor fireplace that you want to show off – it can be a part of a unified look using contemporary furniture and well-planned planting to bring it all together. The outdoor fireplace is made of Corten steel which after a short period of time develops a trendy oxidised surface finish.



CORTEN STEEL

GRILL

FIRE-SCREEN

USER FRIENDLY

### JØTUL TERRAZZA

### INFO



Jøtul Terrazza can be left outside the whole year to be enjoyed for both chilly summer evenings and cold autumn days.

WEIGHT APPROX.: 30 kg  
DIMENSIONS (HxWxD): 1180/500/500 mm

ACCESSORIES: Grill, fire-screen.



The grill provides a large surface for grilling.

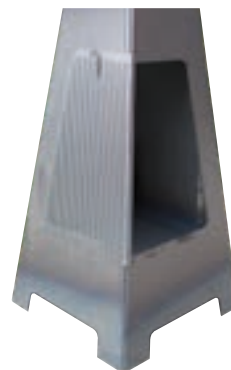

The fire-screen may be installed as necessary and is designed to allow for one side open.



## FACTS TO NOTE WHEN YOU ARE LOOKING FOR A NEW FIREPLACE

### How important is ventilation?

A fireplace needs a supply of air in order to avoid smoke spilling out of the fireplace and to ensure optimal combustion. External air is supplied through wall mounted air vents, a separate external air channel or it is connected directly to the fireplace when it is possible. Vents in the window frame are for the most part not sufficient.

### Closed combustion

Today's requirements for new houses to be closed and requirements for "balanced" ventilation requires some kind of external air connection / air supply to the fireplace to ensure the correct combustion. Products featuring a closed combustion system collect air from a separate air channel directly to the stove through an outer wall or through the floor. Closed combustion also provides economic heating as it does not "steal" heated air to use for combustion. Building regulations

Where is the fireplace going to go? In order to get the optimal joy and use from the fireplace, it is important to choose the right shape, look, size and placement in the house. You might want to make a sketch showing the placement of the chimney in relation to the living area and perhaps the fireproof wall and the size of the fireproof wall. Your Jøtul retailer will provide help to place and choose a your new fireplace correctly.

requires that new houses install wood burning fireplaces with a closed combustion system.

### What type of chimney do you have?

It is an advantage that you know the internal dimensions and height of the chimney when you choose your fireplace. If the cross-section is too small, the height is too low or there are too many fireplaces using one chimney, this often causes poor draught to the fireplace.

### What load can your floor handle?

Fireplaces from Jøtul do not usually require reinforcements of the floor. However, if you wish to have a heavier fireplace surround, for example natural stone, it might be necessary to reinforce the floor.

### What is your heating requirement?

The need for heating depends on the type of house you have, the insulation and climate.

A house with a normal amount of insulation, double-glazed windows and located in areas where the average temperature is -10 to -12 degrees, has a need for heat of 60 to 70 watts per m<sup>2</sup>. In addition, it might be a good idea to calculate a bit extra for periods of extreme cold weather.

### Heating capacity

The heating capacity are guidelines since building standards and hearth placement is very important. We have given an approximate square value, which we hope will make the choice of fireplace or wood stove easier. This is based on the stoves maximum output and it is based in a house with standard flueing and good insulation and central positioning of the stove. The same applies to the choice of wood, how hard you fire and if there is a new or closed building. The values are therefore to be regarded as normative and instructive.

---

### DO YOU NEED HELP WITH INSTALLATION?

The Jøtul retailer often offers a complete installation service to ensure that the fireplace is installed according to all regulations. The product is delivered with installation instructions. The fireplace must be inspected by a qualified inspector, for example an approved business or approved local inspection authority, before use. After the inspection has been carried out, a declaration or copy of the inspection form must be sent to the local chimney sweep association to report that changes were made to an existing fireplace or a new one was installed.





## QUALITY OF JØTUL ENAMEL

Jøtul was the first manufacturer on the market with porcelain enamel for wood stoves manufacturer more than 50 years ago on the market. Durable, semi-gloss porcelain enamel surfaces are not only the best, but also the most beautiful. It highlights the contrast between textured and smooth surfaces in a very tasteful way.

**"An enamelled surface is durable and maintenance-free"**

The secret behind the remarkable enamel quality is the production process. The moulding process itself is vital to get cast iron of the correct quality, which in turn is a requirement for optimal enamel quality. Before the products are coated with the enamel, they receive one more round of sandblasting to remove oxides and graphite from the surface and to make it rougher so that the enamel can adhere itself properly to the cast iron. This is why we can guarantee the best enamel quality that will last "forever".

Today, we deliver products in different degrees of gloss. Some are matt gloss, others are glossy and we also offer products with majolica enamel.

The common denominator for all the enamelled surfaces is that they are durable and maintenance-free, so that you and your family can enjoy your Jøtul wood stove for several generations.

With use enamel adopts a "crazed" finish. This is normal and to be expected and enhances the appearance of a Jøtul stove.

---

## A SMALL SELECTION OF COLOURED SURFACES



Blue black enamel



Brown Majolica enamel



Ivory enamel



## BURNING WOOD/ TIPS ABOUT WOOD

If you plan to chop the wood yourself, this should be done early in the spring. The wood is chopped in shorter lengths before it is split and stacked outside through the summer. The wood contains a lot of water, so remember to store the wood in an airy place where it can get rid of this water.

In order to check if the wood is dry enough, you can bang the logs against each other and listen out for a “singing” sound. If you put a log of wood in a tight plastic bag in a warm room, moisture on the inside of the bag reveals whether the wood is too moist. However, dry wood is most easily recognised by visible dry cracks.

### Tips for burning wood

There are several ways to light a fire, but it is always important to pay attention to what you put in. You should never burn painted or impregnated wood or plastic containing chlorine (PVC), which give off extremely toxic gasses. Do not use driftwood as firewood. It contains salt which turns into chlorine when it is burned. Driftwood should be washed and left outside in all types of weather for at least a couple of years. Wood that is stored outside or in cold rooms should be brought in at least 24 hours before

you plan to use it so that it reaches room temperature. Chop the kindling wood to approx. 4 cm diameter. This will make it easier for you to start the fire and provide more rapid draught in the chimney.

Before you light the fire, you should open all air vents. Some wood stoves only have one, while others have two. The easiest method for lighting a fire is to:

- Put two logs on the bottom of the burn chamber and stack kindling wood in layers up to the holes for tertiary air. Finish with a semi-large log on the top.
- Put 2 or 3 firelighters or similar underneath the top layer of kindling wood and light up.
- Under normal draft conditions, you may now close the door and the fire will take care of itself.

Another variant is to put two big logs on either side of the fireplace. Put some crumpled up paper in between them and put the kindling

wood on top. Later you can add paper as necessary. It might be necessary to make sure that the fire gets enough air for the first 10-15 minutes. Depending on the draught conditions, you may need to supply extra air with the stove door ajar.

Add fuel to the fire often, but only a little fuel at a time. If you burn the fire too hard, the heat load in the chimney might get unnecessarily hard. Burn in a moderate manner. The best indication of a good fire is almost invisible smoke from the chimney.

Jøtul strongly recommend the use of a thermometer on the stove or flue pipe to assist in the operation of your stove and a moisture meter to monitor the moisture content of your wood.



Lighting a fire is easy if you follow the instructions from Jøtul. Please read our instructions on [jotul.com](http://jotul.com) for more tips and good advice.



# IT IS EASY TO INSTALL A FIREPLACE

The number of elements depends on the size of the fireplace, but usually there is few parts involved and easy assembly. You need angle grinder or saw if you need to cut out room for the chimney. Please read the instruction manual before getting started.

Most people can install the easiest fireplaces in a day, while the bigger models require a bit more time. When the fireplace is finished, you should check for any wounds or irregularities in the concrete, which will have to be filled to achieve the best possible result.

You should use sandpaper to check the fireplace and even out small irregularities and sharp edges before you paint it.

Our fireplaces come ready spackled and three layers of white priming paint, so at least one top coat of paint is necessary.

Floor plates and shelves are accessories.

Shelves do not come with all fireplaces; please see the specifications for each model. The Jøtul retailer might be able to help with a complete installation.

Follow the installation instructions that come with the surround and insert step by step. It doesn't get easier than this.



1



2



3



4



5



6





## 10 YEARS – THE LONGEST WARRANTY ON THE MARKET

Your satisfaction revolves around our guarantee all Jøtul stoves and fireplaces are covered by a conditional 10-year guarantee from the date of purchase, against failure due to faulty manufacture if installed by a suitably qualified engineer.

The 10 year warranty is only available for appliances that have been purchased from an authorised Jøtul dealer and have been registered with Jøtul UK at [www.jotulgroupspares.com](http://www.jotulgroupspares.com) you may also ask your authorised dealer to register your new appliance for you.

Failure to buy your appliance from an authorised dealer and or not registering your purchase will by default result in only our standard 12 month warranty being given.

We wish to offer our customers the best of the best, and for this reason all products are handmade in Norway from the best available materials. The exceptional durability is the reason that Jøtul offers a 10 year warranty against failure due to faulty manufacture – the longest on the market.

Warranty includes all components except consumables (grates and flame path equipment) and does not include labour.

### This guarantee does not cover:

- Flame path or consumable equipment such as baffles, grates, firebricks, glass, ash pans, painted finishes and sealing materials such as ceramic rope and fire cement.
- Any damage resulting from improper installation or incorrect use.
- The use of non-approved Jøtul replacement parts, which will invalidate this guarantee.
- With use enamel adopts a “crazed” finish. This is normal and to be expected and enhances the appearance of a Jøtul stove.

### Please Note:

- The use of any petroleum based fuels revokes this guarantee.
- The Jøtul gas burner equipment is guaranteed for 1 year only.
- This guarantee does not affect your statutory rights.

## INTERNET POLICY - CONSUMERS

Jøtul's products are sold through a network of highly trained retailers, able to offer you the very best advice on the most suitable stove for your individual needs and circumstances, with the option of installation and appropriate after sales service for your purchase.

In order to ensure that you benefit from this, we do not recommend purchasing a Jøtul stove over the Internet where this level of advice and service may not be available. If you do decide to buy your stove over the

Internet, ensure that you buy from a dealer who can offer expert advice on the most suitable product for your needs, and who is able to install your stove and service it when necessary.

In particular, we would suggest that you avoid buying Jøtul stoves over the Internet, especially from a retailer who is not local to you, and who is, therefore, unlikely to be able to provide you with the appropriate support.



# TECHNICAL DIMENSIONS

## JØTUL F 602 - Page 28

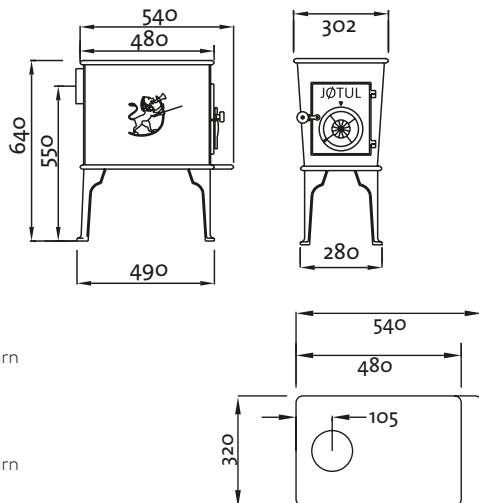

Catalogue Number:

- 320086 Glass door - cleanburn (Blue-black enamel)
- 320100 Glass door (Black paint)
- 320089 Glass door - cleanburn (Black paint)

Finish Options:

Matt Black paint (Standard)  
Matt Black paint  
Blue-black enamel (Cleanburn with glass door)

Heat Output:

Min 1 kW,  
Rated 6 kW  
Max 8.5 kW

Maximum Log Length:

400 mm

Flue Outlet:

Top / Rear

Flue Size:

125 mm / 5" dia.  
(adaptor required)

Accessories:

- Adaptor to 5" (ADPT602)

## JØTUL F 118 CB - Page 28

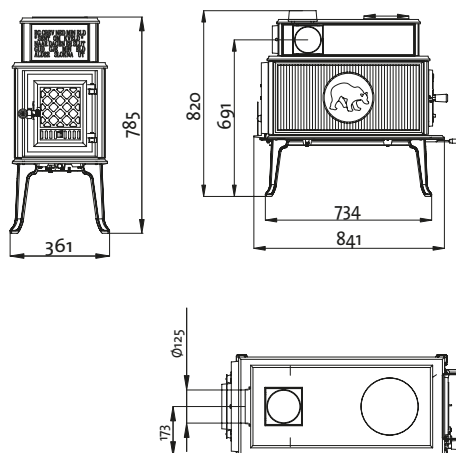

Catalogue Number:

- 320096 (Black paint)

Finish Options:

Matt Black paint

Heat Output:

Min 4.0 kW,  
Rated 7.0 kW  
Max 11.0 kW

Maximum Log Length:

600 mm

Flue Outlet:

Top / Rear / Both sides

Flue Size:

150 mm / 6" dia.  
(adaptor included)

Accessories:

- Rear Heat Shield (320098)
- Side Heat Shield (320099)

## JØTUL F 100 - Page 32

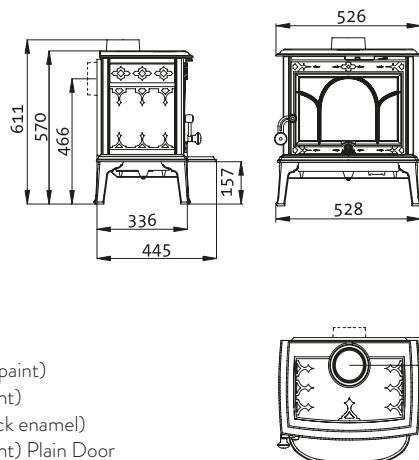

Catalogue Number:

- 350738 Wood burner (Black paint)
- 350710 Multi Fuel (Black paint)
- 350711 Multi Fuel (Blue-black enamel)
- 350794 Multi Fuel (Black paint) Plain Door

Finish Options:

Matt Black paint  
Blue-black enamel (multifuel only)

Heat Output:

Min 2.7 kW,  
Rated 5.0 kW  
Max 7.5 kW

Maximum Log Length:

400 mm

Flue Outlet:

Top / Rear

Flue Size:

125 mm / 5" dia.

Accessories:

- Multi-fuel Kit (350718)
- Long legs - Black paint (350735),  
Blue-black enamel (350736)





## General note for all stoves and fireplaces

1. Please note that the minimum heat output is achieved with the cleanburn system (where applicable) performing.
2. Please note that the rated output is based on laboratory achieved results when tested under DIN, EN or CE approval conditions.
3. Figures given for heat output are based on refuelling with wood every two hours. Outputs vary depending on the quality of the fuel used and refuelling periods.

### JØTUL F 3, JØTUL F 3 TD, JØTUL MF 3 - Page 34

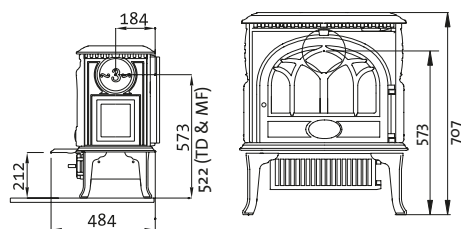

Catalogue Number:

- 350329 Jøtul F 3 (Black paint)
- 350330 Jøtul F 3 (Blue-black enamel)
- 350331 Jøtul F 3 (Ivory enamel)
- 351108 Jøtul F 3 (Majolica Brown enamel)
- 350140 Jøtul F 3 TD (Black paint)
- 350924 Jøtul MF 3 Multi Fuel Plain Door (Black paint)

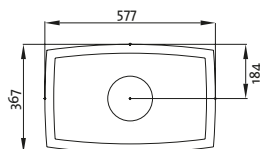

Finish Options:

Matt Black paint  
Blue-black enamel  
Ivory enamel \*  
Majolica Brown enamel

Heat Output: Min 3.4 kW / Rated 6 kW / Max 9.0 kW

Maximum Log Length: 460 mm

Flue Outlet: Top / Rear / Side

Flue Size: 150 mm / 6" dia.

Accessories:

- Multi-fuel grate for Jøtul F 3 TD † (350282)
- Multi-fuel ashpan for Jøtul F 3 TD † (190020)
- Multi-fuel bottom tray for Jøtul F 3 TD † (190021)
- Firescreen (350166)
- Short Legs (155 mm) - available in all colours - (reduces the overall height by 65 mm)
- Décor Rings - available in all colours

\* Top/rear exit only on ivory enamel (not side)

† For conversion of Jøtul F 3 TD only – all 3 items required

### JØTUL F 8 - Page 32

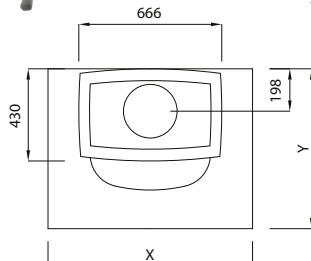
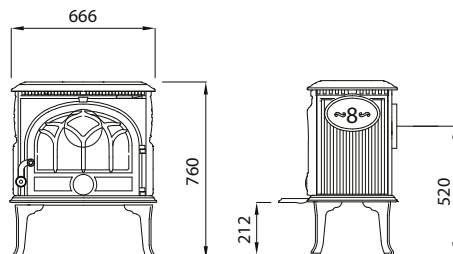

Finish Options:

Matt Black paint

Heat Output: Nominal approx 8.0 kW

Maximum Log Length: 460 mm

Flue Outlet: Top / Rear

Flue Size: 150 mm / 6" dia.

Air system: Air wash system and ignition vent

Combustion system: Standard

Flue outlet: Top and rear

Flue dimension: 150/175 mm dia.

Approx. weight: Fireplace 115 kg

Heating area (headroom 2,4 m): approx 135 m<sup>2</sup>

### JØTUL F 400 - Page 32

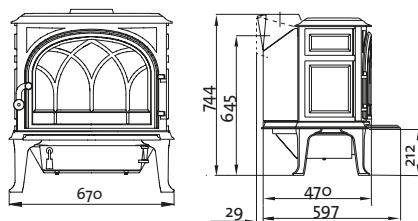

Catalogue Number:

- 350758 (Black paint)
- 350759 (Blue-black enamel)
- 350760 (Ivory enamel)
- 351109 (Majolica Brown enamel)

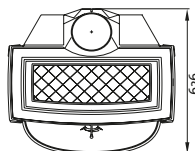

Finish Options:

Matt Black paint  
Blue-black enamel  
Ivory enamel  
Majolica Brown enamel

Heat Output: Min 3.9 kW, Rated 7.5 kW, Max 10.5 kW

Maximum Log Length: 500 mm

Flue Outlet: Top / Rear

Flue Size: 150 mm / 6" dia.

Accessories:

- Short Legs (155 mm) - available in all colours - (reduces the overall height by 65 mm)
- Outside Air Spigot (221031)





## TECHNICAL DIMENSIONS

### JØTUL F 500 - Page 33

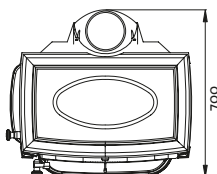
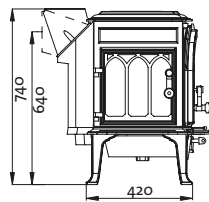
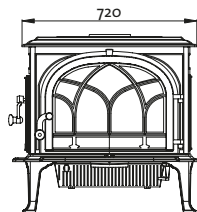

Catalogue Number:

- 350420 (Black paint)
- 350421 (Blue-black enamel)
- 350423 (Ivory enamel)
- 351110 (Majolica Brown enamel)
- 351249 (Plain door, Black paint)
- 351224 (Majolica Green enamel)

Finish Options:

Matt Black paint  
Blue-black enamel  
Ivory enamel  
Majolica Brown enamel  
Majolica Green enamel

Heat Output:

Min 4 kW  
Rated 8.5 kW  
Max 11.0 kW

Maximum Log Length:

550 mm

Flue Outlet:

Top / Rear

Flue Size:

150 mm / 6" dia.

Accessories:

- Outside Air Spigot (221031)

### JØTUL F 600 - Page 33

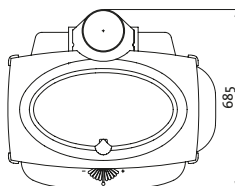
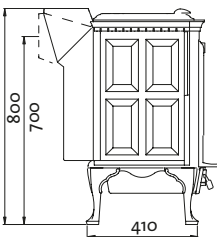
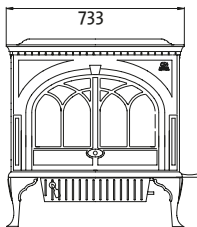

Catalogue Number:

- 350775 (Black paint)
- 350776 (Blue-black enamel)
- 350778 (Ivory enamel)
- 351111 (Majolica Brown enamel)

Finish Options:

Matt Black paint  
Blue-black enamel  
Ivory enamel  
Majolica Brown enamel

Heat Output:

Min 3.5 kW  
Rated 9.5 kW  
Max 12 kW

Maximum Log Length:

550 mm

Flue Outlet:

Top / Rear

Flue Size:

150 mm / 6" dia.

Accessories:

- Outside Air Spigot (221032 + 341296)

### JØTUL I 18 HARMONY, JØTUL I 18 PANORAMA - Page 45

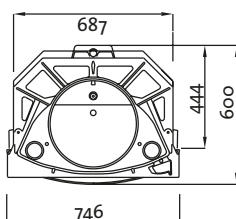
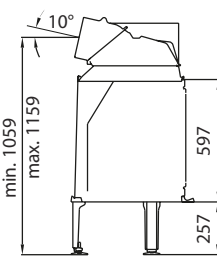
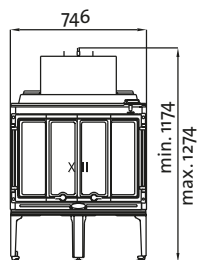

Catalogue Number:

- 341103 Jøtul I 18 Harmony
- 341100 Jøtul I 18 Panorama

Finish Options:

Blue-black enamel

Heat Output:

Min 3 kW,  
Rated 10 kW  
Max 15 kW

Maximum Log Length:

500 mm

Flue Size:

175 mm / 7" dia. internal  
200 mm / 8" dia. external

Door Styles:

Harmony  
Panorama

Accessories:

- Canopy, complete with side panels (190002)
- Firescreen (panorama model only)
- Internal Ash Solution (340809)
- Decorative Plinth (190030)





## JØTUL I 80 RH HARMONY - Page 45



Catalogue Number:  
• 341124 Jøtul I 80 RH Harmony

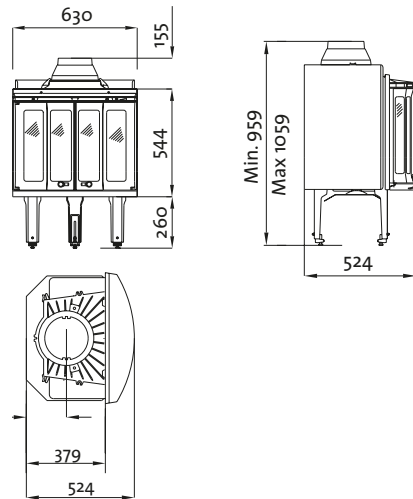

Finish Options: Matt Black paint  
Heat Output: Min 2 kW,  
Rated 9.0 kW  
Max 10 kW  
Maximum Log Length: 400 mm  
Flue Size: 175 mm / 7" dia. internal  
200 mm / 8" dia. external

Accessories:  
• Canopy, complete with side panels (190001)  
• Damper (340955)  
• Decorative Plinth (190005)

## JØTUL I 400 - Page 45



Catalogue Number:  
• 341255 Jøtul I 400 FL Grey paint  
• 341253 Jøtul I 400 Harmony Black paint  
• 341254 Jøtul I 400 Panorama Black paint

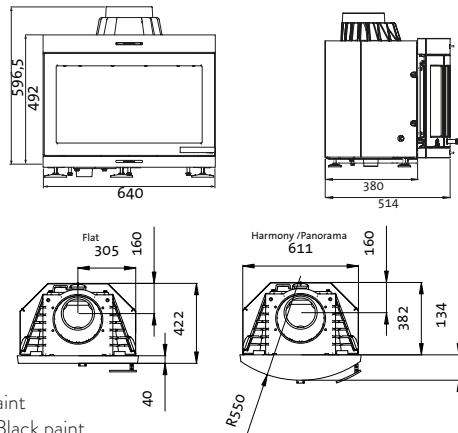

Finish Options: Matt Black paint  
Heat Output: Min 3.7 kW  
Rated 6 kW  
Max 9.0 kW  
Maximum Log Length: 400 mm  
Flue Outlet: Top / Rear  
Flue Size: 150 mm / 6" dia. internal  
175 mm / 7" dia. external

Accessories:  
• Outside Air Kit (341279)  
• Ash solution (341280)  
• Canopy – narrow (190400)  
• Plinth (190401)  
• Canopy – wide (190402)

## CANOPIES & PLINTH JØTUL I 18, JØTUL I 80, JØTUL I 400 - Page 45

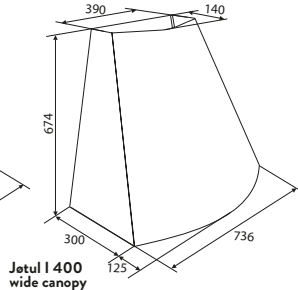
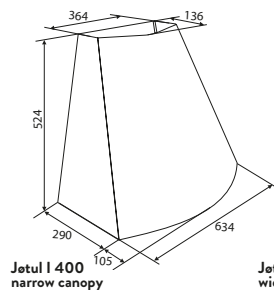
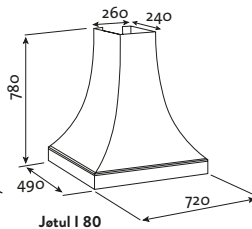
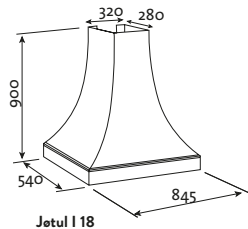
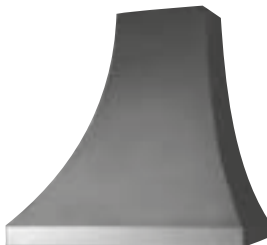

Canopies are supplied complete with a set of matching side panels, and sprayed Matt Black with High temperature paint. Made to measure canopies are available at extra cost.

Decorative Base Plinth available for Jøtul I 18, Jøtul I 80 and Jøtul I 400 Harmony and Panorama models.

Catalogue Number:  
• 190001 to suit Jøtul I 80  
• 190002 to suit Jøtul I 18  
• 190400 narrow to suit Jøtul I 400  
• 190402 wide to suit Jøtul I 400  
• 190005 Decorative Plinth for Jøtul I 80 Harmony and Panorama models. Height 80 mm  
• 190030 Decorative Plinth for Jøtul I 18 Harmony and Panorama models. Height 80 mm.  
• 190401 Decorative plinth for Jøtul I 400 Height 80 mm.





# TECHNICAL DIMENSIONS

## JØTUL C 24 - Page 46



Catalogue Number:  
• 30044102 Jøtul C 24

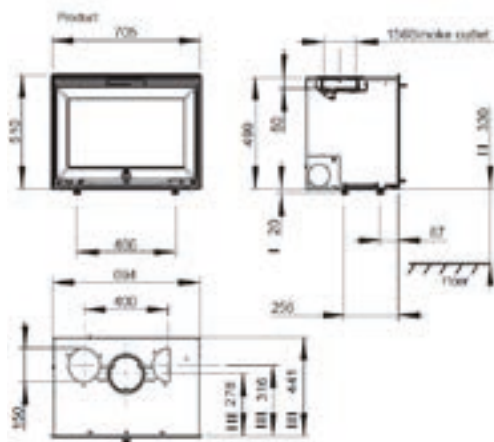

Finish Options: Matt Black paint  
Heat Output: Min 4 kW  
Rated 7 kW  
Max 10 kW  
Maximum Log Length: 500 mm  
Flue Outlet: Top  
Flue Size: 150 / 6" dia.

Accessories:  
• Ash solution  
• Riddling grate  
• Kit for outside air  
• Tangential fan  
• Wide frame

## JØTUL C 31, JØTUL C 33 - Page 46



Catalogue Number:  
• 340859 Jøtul C 31 (Blue-black enamel)  
• 341186 Jøtul C 33 (Blue-black enamel)

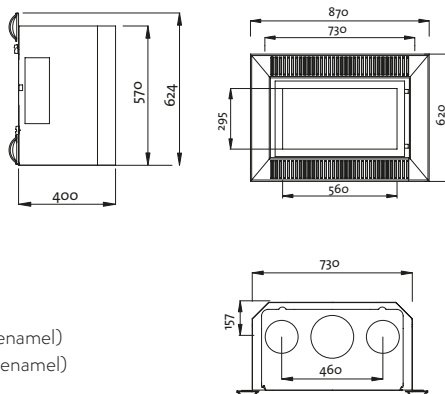

Finish Options: Blue-black enamel  
Heat Output: Min 2 kW,  
Rated 8 kW  
Max 10 kW  
Maximum Log Length: 550 mm  
Flue Outlet: Top  
Flue Size: 175 mm / 7" dia

Accessories:  
• Flue Connector Kit (340856)

## JØTUL I 520 - Page 44



Catalogue Number:  
• 30044743 Jøtul I 520 F Front glass  
• 30044744 Jøtul I 520 FL Front and left glass  
• 30044745 Jøtul I 520 FR Front and right glass  
• 30044746 Jøtul I 520 FRL Front, right and left glass

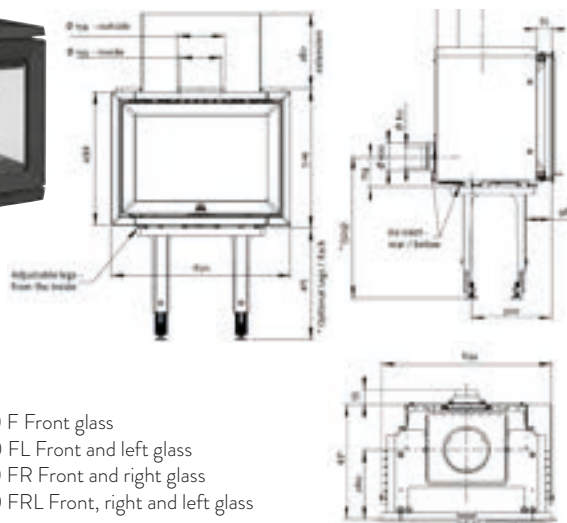

Finish Options: Matt Black paint  
Heat Output: Min 3.9 kW  
Rated 7 kW  
Max 10 kW  
Maximum Log Length: 500 mm  
Flue Outlet: Top / Rear  
Flue Size: 150 / 6" dia.

Accessories:  
• Leg rack complete (51044759)  
• Convection top complete I 520 F (50045755)  
• Dock lock complete left I 520 (right hinge) (50045754)  
• Cassette grid I 520 F (50045747)  
• Cassette grid I 520 FR (50045748)  
• Cassette grid I 520 FL (50045749)  
• Frame wide I 520 F 60 mm (50045750)  
• Frame wide I 520 FL/FR 60 mm (50045751)  
• Frame wide I 520 FRL 60 mm (50045752)  
• Kit for outside air, 100 mm (std) (51012164)







Finish Options: Black paint  
 Heat Output: Min 3 kW  
 Rated 5 kW  
 Max 9.0 kW  
 Maximum Log Length: 330 mm  
 Flue Outlet: Top / Rear (not Jøtul F 162 C)  
 Flue Size: 150 mm / 6" dia.

Catalogue Number:  
 • 351223 (Jøtul F 162 Black paint)  
 • 351238 (Jøtul F 163 Black paint with side glass)  
 • 351273 (Jøtul F 163 Black enamel)  
 • 351272 (Jøtul F 163 White enamel)  
 • 30044115 (Jøtul F 164 Black paint)  
 • 30044116 (Jøtul F 165 Black paint with side glass)  
 • 51044401 (Jøtul F 164 S Black paint with soapstone)  
 • 51044401 (Jøtul F 165 S Black paint with side glass and soapstone)  
 • 30044528 (Jøtul F 166 Black paint with pedestal)  
 • 30044529 (Jøtul F 167 Black paint with pedestal and side glass)

Accessories:  
 • Soapstone top (361080)  
 • Soapstone top Jøtul F 162, Jøtul F 163 (361080)  
 • 100 mm short legs (BP only)  
 • External air supply kit (341296)  
 • Cover for legs when using external air supply (361083)  
 • Convection top (361099)  
 • Convection side for Jøtul F 162 C (361084)  
 • Convection side for Jøtul F 163 C (361114)

Jøtul F162 /F163

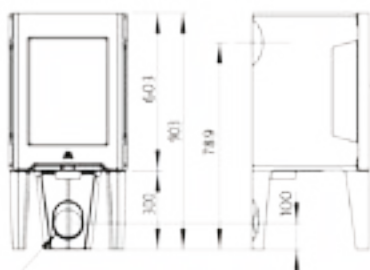

Jøtul F162 C /F163 C

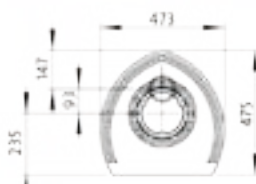
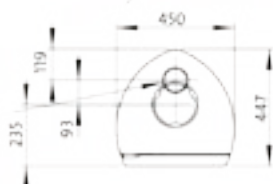
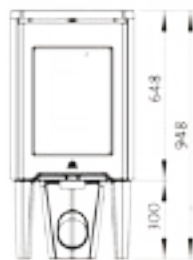

Jøtul F166/F167

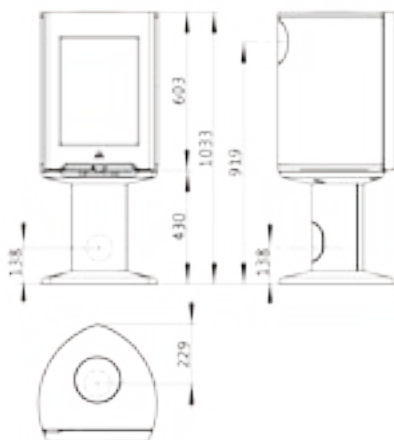

Jøtul F162 C /F163 C

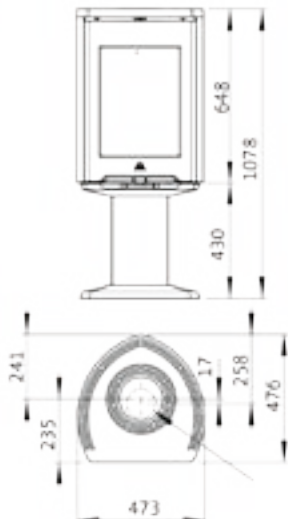

Jøtul F164 /F165

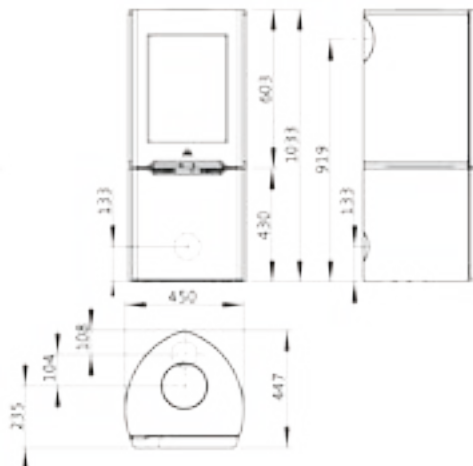



# TECHNICAL DIMENSIONS

## JØTUL F 262 / F 262 S / F 263 / F 263 S - Page 19

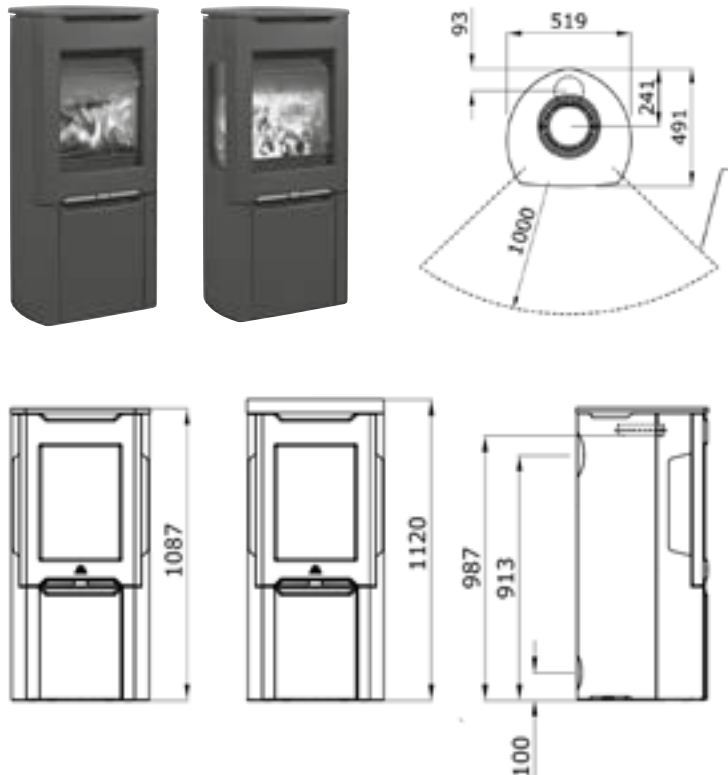

Finish Options: Black paint  
 Heat Output: Min 3.7 kW  
 Rated 5 kW  
 Max 9.0 kW  
 Maximum Log Length: 330 mm  
 Flue Outlet: Top and rear  
 Flue Size: 150 mm / 6" dia.

Accessories:  
 • Soapstone Top Plate (223559)  
 • Fan for rapid heat (50036914)  
 • Kit for connection to an external air supply (341296)

Catalogue Number:  
 • 351245 Jøtul F 262  
 • 351246 Jøtul F 263 with side glass

Must be ordered with steel side panel set (351247) or soapstone panel set (351248)

## JØTUL F 305 CONCEPT - Page 16

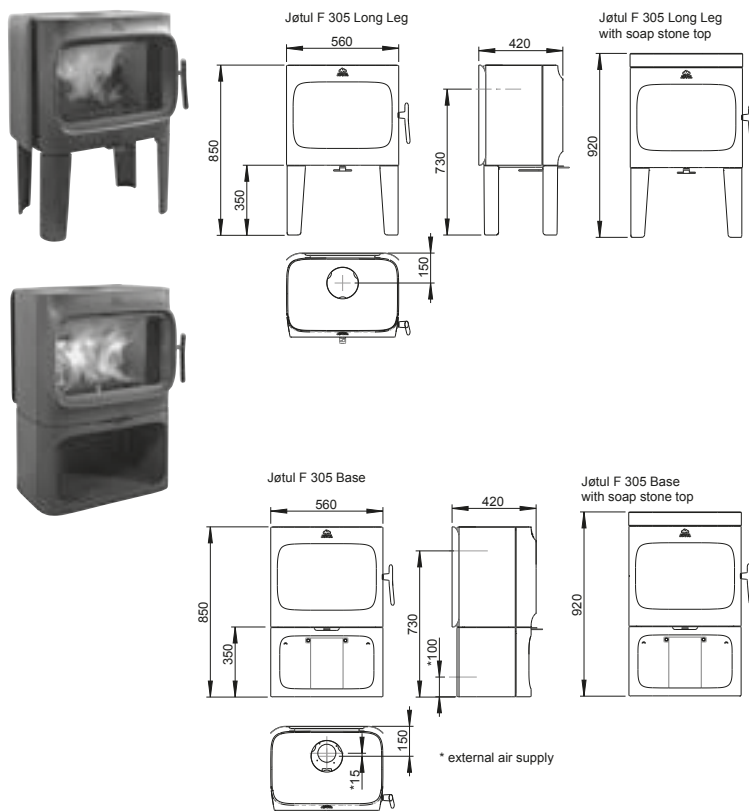

Finish Options: Black paint  
 Heat Output: Min 3.7 kW  
 Rated 7.0 kW  
 Max 10 kW  
 Maximum Log Length: 410 mm  
 Flue Outlet: Top and rear  
 Flue Size: 150 mm / 6" dia.

Accessories:  
 • Soapstone Top Plate (223559)  
 • Floor plate in steel or glass  
 • Kit for connection to an external air supply (341296)

Catalogue Number:  
 • 30044996 Jøtul F 305 LL  
 • 30046816 Jøtul F 305 B





## JØTUL F 370 CONCEPT - Page 20

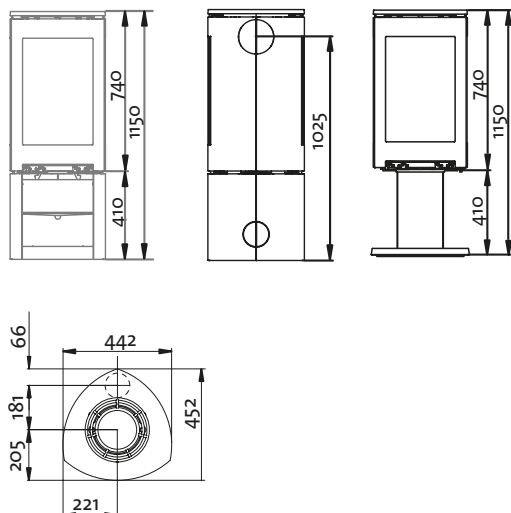

Catalogue Number:

- 350972 Jøtul F 371 (Black paint plus black cast iron open shelf stand 350982)
- 350972 Jøtul F 373 (Black paint plus black pedestal 350974)
- 350972 Jøtul F 374 (Black paint with cast pillar 351162)
- 350972 Jøtul F 375 (Black paint with glass door cast base 351176)
- 350972 Jøtul F 376 (Black paint with glass base 351210)
- 351160 Log box for F 374 Black paint

Finish Options: Black paint  
 Heat Output: Min 3.5 kW  
 Rated 5.5 kW  
 Max 7 kW  
 Maximum Log Length: 300 mm  
 Flue Outlet: Top / Rear  
 Flue Size: 150 mm / 6" dia.

Accessories:

- Soapstone top (350992)
- Glass panels top, sides and front "rear flue" BP (350993)
- Glass panels top, sides and front "top flue" BP (350995)
- Pedestal Rotating Kit (360°) (350997)
- Steel decorative floorplate BP (351158)

## JØTUL F 370 HIGH TOP CONCEPT - Page 20

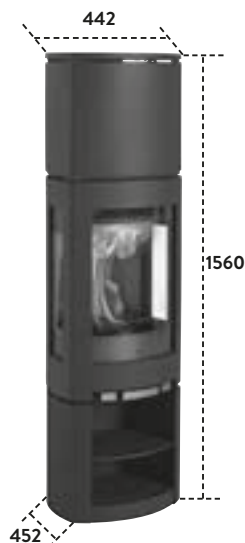

**Jøtul F 371 High Top**

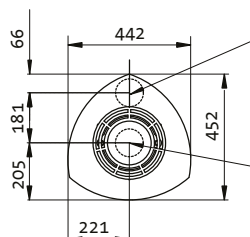

*Hole in floor for external  
 air supply Ø100 mm  
 connection  
 Jøtul F 371, F 374,  
 F 375, F 376*

To Suit:

Jøtul F 371  
 Jøtul F 375  
 Jøtul F 376

Catalogue Number:

- 351243 Jøtul F 370 High Top Concept

Accessories:

- Heat Accumulating Stones Soapstone top (350992)





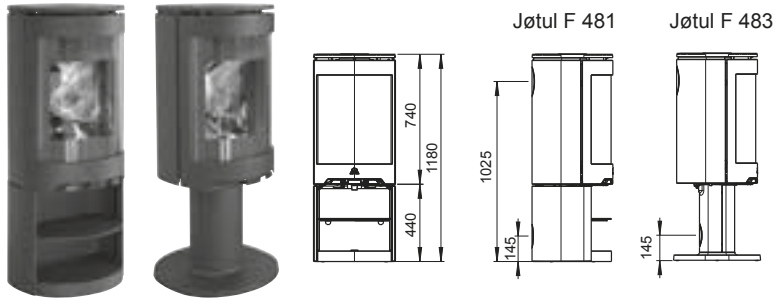

Finish Options: Black paint  
 Heat Output: Min 3.5 kW  
 Rated 6.0 kW  
 Max 10.0 kW  
 Maximum Log Length: 300 mm  
 Flue Outlet: Top / Rear  
 Flue Size: 150 mm / 6" dia.

Accessories:  
 • Floor plates in glass or steel  
 • 80 mm kit for connection to an external air supply (51047509)

Jøtul F 483 with turntable

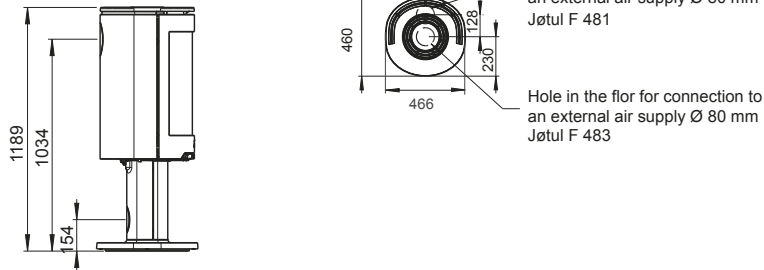

Catalogue Number:  
 • 30047088/51047110/51047124 Jøtul F 481  
 • 30047088/51047117/51047124 Jøtul F 483

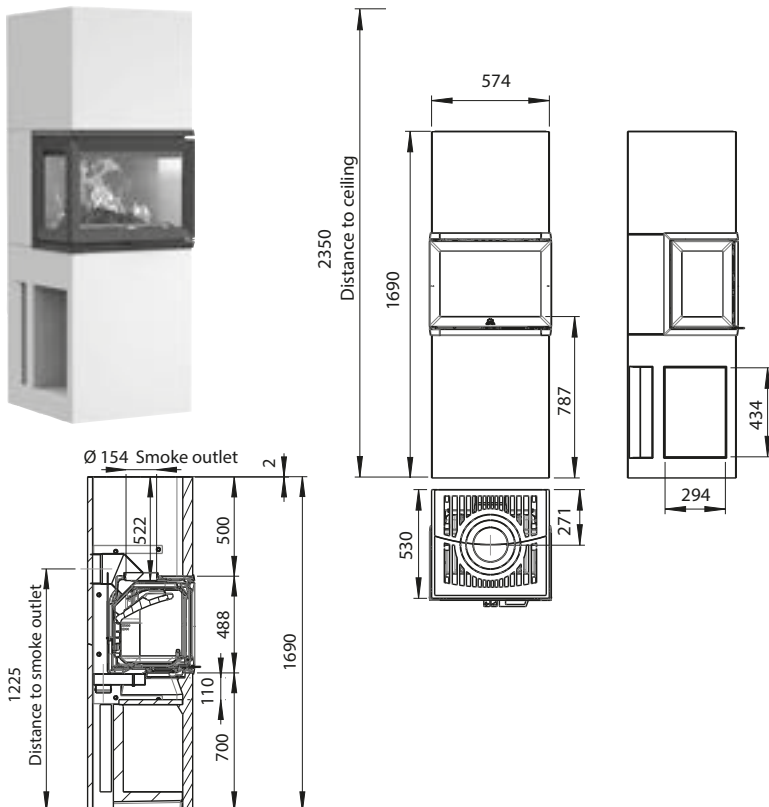

Black paint/lightweight concrete  
 Inserts: Jøtul I 520 insert  
 Heat Output: Min 3.9 kW  
 Rated 7 kW  
 Max 10 kW  
 Maximum Log Length: 500 mm  
 Flue Size: 150 / 6" dia.  
 HxWxD (73) 1690x574x530 mm  
 (74) 1690x574x600 mm

Catalogue Numbers:  
 • 51046197 Jøtul FS 73  
 • 51046196 Jøtul FS 74





Finish Options: Delivered primed and ready for painting  
 Inserts: Jøtul 480 insert  
 Heat Output: Min 3.5 kW  
 Rated 6 kW  
 Max 10 kW  
 Maximum Log Length: 300 mm  
 Flue Outlet: Top / Rear  
 Flue Size: 150 mm / 6" dia.  
 HxWxD 1570x525x480 mm

Catalogue Numbers:  
 • 30044643 Jøtul FS 91 Surround  
 • 30044644 Jøtul FS 92 Surround  
 • 30047088 Jøtul F 480 burn chamber

Accessories:  
 • Glass floorplate (50044652)  
 • Glass decor (50044653)

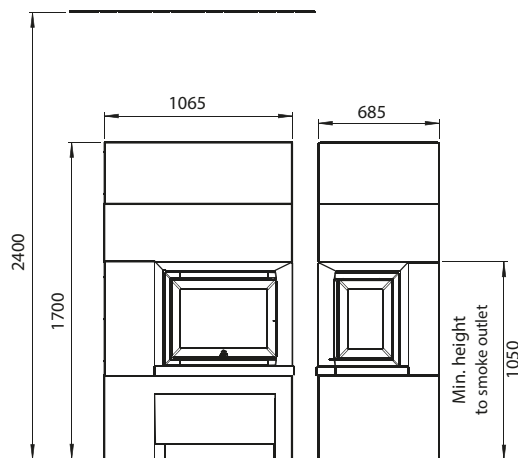

Finish Options: Black paint/lightweight concrete  
 Inserts: Jøtul I 520 insert  
 Heat Output: Min 3.9 kW  
 Rated 7.0 kW  
 Max 10.0 kW  
 Maximum Log Length: 500 mm  
 Flue Size: 150 / 6" dia.  
 HxWxD 1700x1065x685 mm

Catalogue Numbers:  
 • S71 FR 30044745  
 • S72 FL 30044744

Accessories:  
 • Floor plates in steel or glass (51047337/338)  
 • 100 mm outside air connection (341296)  
 • Adapter for ventilated chimney (51046710)



# GAS DIMENSION AND SPECIFICATION INFORMATION

## JØTUL GF 300 CF - Page 36



*Jøtul GF 300 CF*

Jøtul GF 300 Catalogue Number:

- 351095 Matt Black paint
- 351096 Blue-black enamel
- 351097 Ivory enamel
- 351098 Majolica Brown enamel

Accessories:

- 155648 Antique effect brick panels
- 350173 Short leg Black Paint
- 350174 Short leg Blue Black Enamel
- 350176 Short leg Ivory Enamel
- 351147 Short leg Majolica Brown Enamel

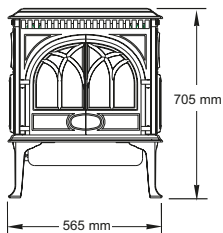

This height can be reduced by 65 mm when using short legs

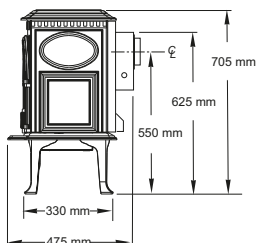

Heat Input (Net kW):	Nat gas 6.3, LPG 6.3	
Heat Output Max	(net kW)	Efficiency
Nat gas - rear flue	5.1 kW	80.6 %
Nat gas - top flue	5.0 kW	79.9 %
LPG - rear flue	5.1 kW	80.9 %
LPG - top flue	5.0 kW	79.5 %
Flue Outlet:	Top or Rear	
Flue Size:	125 mm	
Fuel Effect:	Log only	
Gas Types:	Natural Gas as standard with LPG conversion included	

Suitable for class 1 & 2 and precast flues to BS 1289 parts 1 & 2 as well as Closure Plate installations to BS 5871 parts 1 and BS 5440 part 1.

## JØTUL GF 373 BF - Page 37

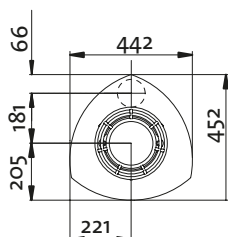
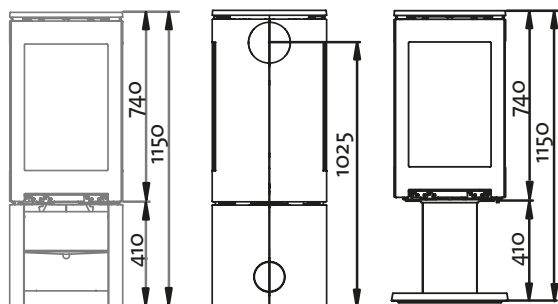

Catalogue Number:

- 351373 Matt Black paint
- 156817 Reflective glass panels
- 351374 White enamel

Please refer to installation manual for balanced flue terminal and pipe configurations & options. Manuals may be downloaded from the Jøtul website [www.jotuluk.com](http://www.jotuluk.com)

Finish Options:	Matt Black paint White enamel	
Heat Output Nat Gas:	5.7 kW Net	
Heat Output LPG:	5.5 kW Net	
Efficiency max. Nat Gas:	82.2 %	
Efficiency max. LPG:	78.4 %	
Fuel Effect:	Log	
Gas Types:	Natural Gas LPG	
Flue Outlet:	Top or top then rear	

Accessories:

- M82650 300 mm vertical terminal
- M82652 600 mm horizontal terminal
- M82653 500 mm fixed length
- M82654 1000 mm fixed length
- M82655 500 mm cutable length
- M82668 325-440 adjustable length
- M82656 90 degree bend
- M82657 45 degree bend x 2
- M82668 325-440 adjustable length
- M82661 locking band
- M82667 wall thimble
- M87196 wall bracket
- M87379 vertical flat roof flashing
- M87913 vertical pitched roof flashing
- M30170 heat shield
- GUARD Horizontal flue guard





## General note for all stoves and fireplaces

The Gas Stove ceramic coal set and log sets are not interchangeable. Short Leg (155 mm) are available for the Jøtul GF 300 BF / GF 300 CF 2 in all colour options. Gas heat output could be effected by chimney or flue conditions. The information on gas stoves does NOT apply to Non domestic settings, which may require special advice with regards fluing. Although every effort has been made to ensure dimensions are accurate, Jøtul (UK) recommends that all apertures / holes needed for balanced flue system installation are first measured by offering up the stove and flue system prior to apertures / holes being made.

### JØTUL GF 300 BF - Page 36



Please refer to installation manual for balanced flue terminal and pipe configurations & options. Manuals may be downloaded from the Jøtul website [www.jotuluk.com](http://www.jotuluk.com)

Finish Options:

Matt Black Paint  
Blue-Black enamel  
Ivory Enamel  
Brown Majolica enamel

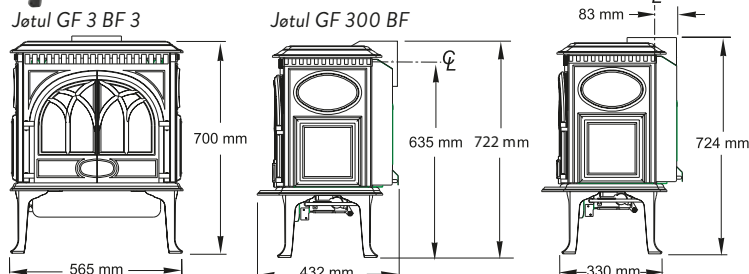

Max Heat Input (Gross) 7.5  
Max Heat Input (Net) 6.8  
Fuel Effect: Log  
Gas Types: Natural Gas/LPG  
Flue Outlet: Top  
Flue Options: Consult manual

Accessories:

155648 Antique effect brick panels

GF 300 BF

351405 Matt Black

351406 Blue-black enamel

351407 Ivory enamel

351408 Brown Majolica enamel

Efficiency(net)	Efficiency (% , net)	Max Heat Output (kW, net)	Configuration*
Nat Gas - rear flue (100/150 mm flue size)	76.6	5.2	45° Spigot + 325-400 mm Adjustable Length + 90° Bend + 100/150 Wall Terminal (c/w 600 mm length attached to terminal) (vent limiter position D)
Nat Gas - top flue (100/150 mm flue size)	73.3	4.9	45° Spigot + 100/150 Roof Terminal (+ vertical rise up to 10m) (vent limiter position A)
LPG - rear flue (100/150 mm flue size)	78.2	5.4	45° Spigot + 325-400 mm Adjustable Length + 90° Bend + 100/150 Wall Terminal (c/w 600 mm length attached to terminal) (vent limiter position D)
LPG - top flue (100/150 mm flue size)	74.4	5.1	45° Spigot+100/150 Roof Terminal (+ vertical rise up to 10m) (vent limiter position A)

### JØTUL GF 400 CF - Page 36

\* Consult manual for flue configuration and flue limiter positioning

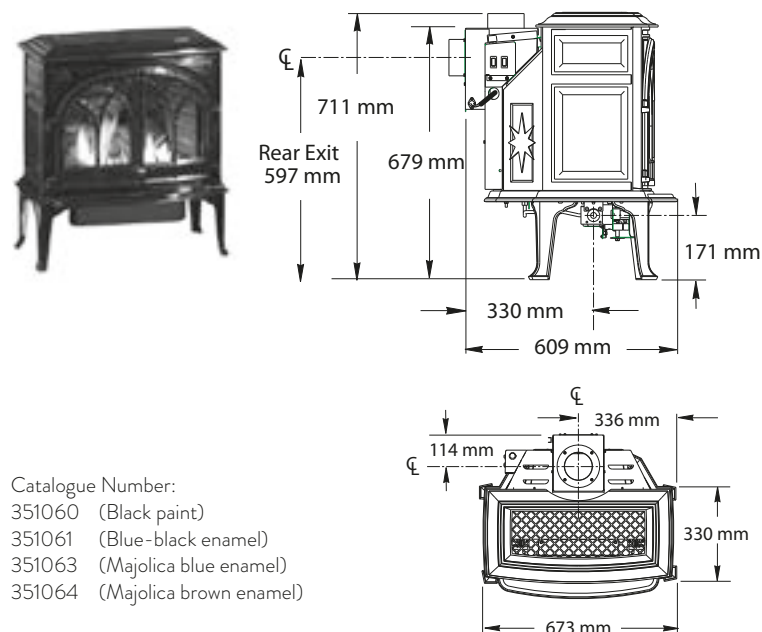

Catalogue Number:

351060 (Black paint)

351061 (Blue-black enamel)

351063 (Majolica blue enamel)

351064 (Majolica brown enamel)

Finish Options:

Matt Black paint  
Blue-black enamel  
Majolica Blue enamel  
Majolica Brown enamel

Heat Input NG: 8.7 kW

Heat Input LPG: 9.3 kW

Heat Output NG: 6.8 kW

Heat Output LPG: 7.2 kW

Efficiency: 77.9 %

Fuel Effect: Log only

Gas Types: Natural Gas

LPG

Flue Size: 125 mm

Flue Outlet: Top/Rear

Accessories:

• Antique effect brick panels (155375)





JØTUL  
FIGHTING THE COLD SINCE 1853









Retailer info:

2014/2015 | Kat. nr. 50046905

“Jøtul – a life-long source  
of warmth and comfort.”